

Meegan Fitzharris MLA

Attachment A: ARRANGEMENTS BRIEF

FUNCTION:	2019 pre-budget announcement on SPIRE
VENUE:	Outside of the Canberra Hospital Main Entrance
HOST:	Name: Liz Lopa, Executive Group Manager of Strategic Infrastructure, ACT Health Directorate Mobile: [REDACTED]
DAY:	Tuesday
DATE:	28 May 2019
TIME:	12 pm
TIME COMMITMENT:	30 minutes
CATERING:	N/A
DRESS CODE:	Business
YOUR ROLE:	To participate in a media doorstep outside of the Canberra Hospital main entrance to make a pre-budget announcement on SPIRE.
WHERE TO PARK:	There will be a car space reserved for you in the Executive Car Park behind Building 24.
WHO WILL MEET YOU:	You will be met at the main entrance to Canberra Hospital (off Hospital Road) by Michael De'Ath and Bernadette McDonald.
ADVISOR ATTENDING:	Claire Johnston
AUDIENCE:	Representatives from the ACT Health Directorate, Canberra Health Services representatives and the Australian National University and local media.
VIPs:	<p><u>ACT Health Directorate/Canberra Health Services:</u></p> <ul style="list-style-type: none"> • Michael De'Ath, Director-General of ACT Health Directorate • Bernadette McDonald, Chief Executive Officer of Canberra Health Services • Liz Lopa, Executive Group Manager of Strategic Infrastructure, ACT Health Directorate • (INSERT other CHS staff participating) • ... • ... • ... • Tracey Pulli, Director of Media, ACT Health Directorate • Charlotte Harper, Acting Director of Communications and Government Relations, Canberra Health Services <p><u>Australian National University:</u></p> <ul style="list-style-type: none"> • (INSERT other CHS staff participating) • ...

PAST INVOLVEMENT:	In December 2018 you announced the change in the location of SPIRE on the Canberra Hospital campus.
SENSITIVITIES:	There has been previous media coverage on delays with the completion of SPIRE.
ORDER OF CEREMONIES	<p>12 pm – Ms Lopa and Ms McDonald to meet Minister Fitzharris at main entrance (off Hospital Road) for the media doorstep.</p> <p>12.05 pm – Media are assembled, and doorstep commences with Minister Fitzharris addressing the media.</p> <p>12.10 pm – Minister Fitzharris to hand over the ANU representative to make comment</p> <p>12.15 pm – Minister Fitzharris to invite questions from media.</p> <p>12.20 pm – Media doorstep concludes and opportunity for overlay footage.</p> <p>12.30 pm – Event concludes and Minister free to depart.</p>
MEDIA:	Media release and media alert prepared.
SOCIAL MEDIA ACCOUNTS	Social media being coordinated through Minister's office.
OUTSTANDING REGULATORY ISSUES:	N/A

**MEDIA TALKING POINTS – PRE-BUDGET ANNOUNCEMENT ON
SPIRE
12PM, TUESDAY 28 MAY 2019**

- Health is one of the Government's biggest priorities.
- The 2019 Budget is future proofing our health care system.
- As part of this, the Government is making major investments in new health infrastructure to meet Canberra's future needs.
- At the Canberra Hospital, this includes the new Surgical Procedures, Interventional Radiology and Emergency Centre (SPIRE), which is the largest health infrastructure project in the ACT.

A bigger and better SPIRE

- Today we are announcing a bigger and better SPIRE following extensive consultation with clinicians.
- The expanded scope means SPIRE will be larger and deliver more services.
- Many of the key aspects of SPIRE have been boosted providing the best outcomes for our community and for our health workforce well into the future.
- SPIRE now deliver:
 - 114 emergency department spaces – 39 more than currently available at Canberra Hospital,
 - 22 new state of the art operating theatres – an increase from the 13 currently available and two more than originally planned,
 - 60 ICU beds – 12 more than originally planned and doubling what is currently available. The new ICU will also include 4 new paediatric ICU beds and have a family zone that will provide families who have children in the ICU access to a support area.
- SPIRE will transform the campus and the acute health services delivered at the hospital.
- The clinicians have been integral in the development of the final scope of SPIRE. I want to thank all who have been involved in that process.

ANU announcement

- A major component SPIRE is the that it will allow for advances in the use of medical technology and techniques and for teaching and learning.
- I am pleased to be joined by the INSERT names from the Australian National University (ANU) today to also announce that SPIRE will now be complemented by a new ANU building that will boost the teaching, training and research presence on the Hospital campus.
- This is a significant announcement and a clear signal that SPIRE will not only transform the campus but will be the point of difference for health system in the ACT.
- The ANU's investment will co-locate medical research, the use of the latest technologies and clinical training and teaching at the Canberra Hospital – a feature of modern health care.
- It will ensure Canberra is best placed to attract the best and brightest students nationally and internationally to do their medical training and research at the Canberra Hospital.

Q&A

If asked about the Budget for SPIRE:

- At this stage in the project, we will not be releasing the total cost of SPIRE.
- As we are move into the procurement process for this project, it is important we don't send any pricing signals to the market.
- SPIRE is the largest health infrastructure project in the ACT and we want the best value for money for the project and the territory.
- The upcoming Budget will confirm the spend on this project for the 2019-20 financial year.

If asked about construction timeframes for the project:

- Construction of SPIRE is anticipated to be completed in 2023-24. This has not changed.
- These changes to the scope of SPIRE have been part of the early design phases of the project and will not impact on these timeframes.



Meegan Fitzharris MLA

Minister for Health and Wellbeing
 Minister for Higher Education
 Minister for Medical and Health Research
 Minister for Transport
 Minister for Vocational Education and Skills

Member for Yerrabi

Tuesday 28 May 2019

A bigger and better SPIRE set to transform Canberra Hospital

Canberra Hospital's new Surgical Procedures, Interventional Radiology and Emergency Centre will be larger and deliver more services for Canberrans as a result of ACT Government investment announced today.

SPIRE, which is the largest health infrastructure project in the ACT, will transform the Canberra Hospital campus and the acute health services delivered at the hospital and will be complemented by a new Australian National University building that will significantly boost the teaching, training and research presence on the Hospital campus.

This expanded scope of the project means SPIRE will deliver 114 Emergency Department treatment spaces – 39 more than currently available at Canberra Hospital – and 60 ICU beds – 12 more than originally planned and doubling what is currently available.

There will be 4 new paediatric ICU beds and a new family zone that will provide families who have children in the ICU access to a support area. There will also be 22 new state-of-the-art operating theatres – an increase from the 13 currently available and two more than originally planned, including hybrid theatres and interventional radiology theatres that will allow for advances in the use of medical technology and techniques.

Minister for Health and Wellbeing Meegan Fitzharris said the expansion of the project is the result of thorough consultation with the clinical workforce over the past 12 months.

"We have engaged with clinicians extensively and we've listened," Minister Fitzharris said.

"The SPIRE Centre we are announcing today will be bigger and better than first planned and will provide the best outcomes for our community and for our current and future health workforce.

ACT Legislative Assembly

Phone (02) 6205 0051 Email: fitzharris@act.gov.au

@MeeganFitzMLA

MeeganFitzharrisMLA





Meegan Fitzharris MLA

Minister for Health and Wellbeing
 Minister for Higher Education
 Minister for Medical and Health Research
 Minister for Transport
 Minister for Vocational Education and Skills

Member for Yerrabi

"Many of the key aspects of SPIRE have been boosted, with this state-of-the-art critical care and surgical facility able to meet the acute healthcare needs of our growing and ageing community well into the future.

"The significant investment by the ANU means Canberra and the SPIRE Centre will be very attractive to the best and brightest students and clinicians nationally and internationally who want to do their medical training and research in a modern, state-of-the-art facility."

Chief Executive Officer of Canberra Health Services Ms Bernadette McDonald welcomed the expansion in the scope of SPIRE and the ANU's contribution.

"SPIRE is an incredibly exciting project to be a part of. It will enhance the level of services at the hospital and will ensure our staff are able to provide the best care possible to their patients," Ms McDonald said.

"Our clinicians have been integral in the development of the final scope of SPIRE being announced today. We have had many conversations about the services that can be delivered in this new facility and it is great to see the outcomes of that work being announced today. I want to thank all who have been involved in that process."

The new Surgical Procedures, Interventional Radiology and Emergency Centre (SPIRE) will be located at the eastern end of the Canberra Hospital campus.

Further information on the new features of SPIRE is available at:

Statement ends

Media contact/s:

Claire Johnston T (02) 6205 0022 M 0452 597 459 ClaireV.johnston@act.gov.au

ACT Legislative Assembly

Phone (02) 6205 0051 Email: fitzharris@act.gov.au

 @MeeganFitzMLA

 MeeganFitzharrisMLA





Meegan Fitzharris MLA

Minister for Health and Wellbeing
 Minister for Higher Education
 Minister for Medical and Health Research
 Minister for Transport
 Minister for Vocational Education and Skills

Member for Yerrabi

Monday 27 May 2018

Announcement on SPIRE at Canberra Hospital

Attention news editors and chiefs of staff

Minister for Health and Wellbeing Meegan Fitzharris will tomorrow make a major announcement on relation Canberra Hospital's new Surgical Procedures, Interventional Radiology and Emergency Centre.

WHAT: Major announcement on SPIRE

DATE: Tuesday 28 May 2019

TIME: 12 pm

WHERE: Outside the main entrance of Canberra Hospital, along Hospital Road

Statement ends

Media contact/s:

Claire Johnston T (02) 6205 0022 M 0452 597 459 ClaireV.johnston@act.gov.au

ACT Legislative Assembly

Phone (02) 6205 0051 Email: fitzharris@act.gov.au

@MeeganFitzMLA

MeeganFitzharrisMLA





Caption: Artist impression of the SPIRE Centre at Canberra Hospital.

Features of SPIRE

The scope of the new Surgical Procedures, Interventional Radiology and Emergency Centre (SPIRE) at the Canberra Hospital has been expanded following extensive consultation with the clinical workforce over the past 12 months. The new Centre will deliver more services for the community in a purpose-built facility.

The expanded scope means SPIRE will include:

- 148 beds and 22 theatres,
- a new and expanded Intensive Care Unit including paediatric intensive care,
- a new and expanded Coronary Care Unit including interventional cardiology services,
- a new and expanded Emergency Department, and
- integrated radiology and medical imaging facilities.

Many of the key aspects of SPIRE have been boosted, with this state-of-the-art critical care and surgical facility able to meet the acute healthcare needs of our growing and ageing community well into the future.

The construction of SPIRE is anticipated to be completed in 2023-24.

Intensive Care Unit

The new Intensive Care Unit (ICU) will expand from the originally planned 48 beds to 60. This is 12 more beds and will double what is currently available.

The new expanded ICU will include:

- 4 specialist paediatric beds, originally part of the expansion of the Centenary Hospital for Women Children,
- A new family zone that will provide families who have children in the ICU access to a support area including a lounge and play area,
- a rehabilitation gymnasium to provide early, integrated rehabilitation - to get ICU patients moving to assist in their recovery,
- a dedicated pod of beds which can be converted into a complete isolation pod in the event of an infectious threat, and
- dedicated critical care bays, which will enable high-end, complex interventions, reducing the need to transfer these patients to interstate facilities.

Emergency Department

The new Emergency Department (ED) will have 114 treatment spaces – 39 more than currently available at Canberra Hospital. In addition, the new ED will include:

- 4 behavioural assessment rooms,
- bariatric and superbariatric treatment spaces,
- a separate paediatrics stream treatment area, and
- other consultation and procedural areas, including specific waiting areas for treatment streams.

Furthermore 10 Mental Health Short Stay Unit treatment spaces will be provided in SPIRE.

Coronary Care Unit

The expanded Coronary Care Unit will include:

- 24 acute cardiac care beds, including bariatric and isolation beds,
- 4 Interventional cardiac laboratories, including one hybrid cardiac laboratory and one electrophysiology laboratory, and
- 27 interventional unit day beds.

Surgical and medical imaging facilities

SPIRE will increase the number of theatres at Canberra Hospital from 13 to 22 – two more than originally planned for the project. This will include state-of-the-art hybrid and interventional radiology theatres to allow the latest advances in medical technology to be used.

SPIRE will add to the medical imaging facilities available at Canberra Hospital, with:

- 2 new X-ray machines,
- 3 CT Scanners, and
- an MRI machine.

SPIRE will also include more inpatient wards with 64 beds for overnight care and storage spaces for important medical equipment.

Teaching and learning

The ANU have announced a new building that will boost the teaching, training and research presence on the Hospital campus.

This is a significant investment in the SPIRE Centre that will co-locate medical research, the use of the latest technologies and clinical training and teaching.

It will ensure Canberra is best placed to attract the best and brightest students and clinicians nationally and internationally.

Contacts

Further information on SPIRE and the BHSP is available on the ACT Health website.

www.health.act.gov.au/infrastructure | BuildingHealthServicesProgram@act.gov.au

Lowes, Shannon (Health)

From: Lopa, Liz (Health)
Sent: Friday, 24 May 2019 1:05 PM
To: Pulli, Tracey (Health)
Cc: Culver, Jakob (Health); Evans, Kate (Health); Dal Molin, Vanessa (Health); Finlay, India (Health)
Subject: RE: SPIRE package - for finalisation [SEC=UNCLASSIFIED]
Attachments: Arrangements brief and talking points (pre-budget) - LL.docx

Hi Trace

All good to go – I just amended the TPs

Liz

From: Pulli, Tracey (Health)
Sent: Friday, 24 May 2019 12:29 PM
To: Lopa, Liz (Health) <Liz.Lopa@act.gov.au>
Cc: Culver, Jakob (Health) <Jakob.J.Culver@act.gov.au>; Evans, Kate (Health) <Kate.Evans@act.gov.au>; Dal Molin, Vanessa (Health) <Vanessa.DalMolin@act.gov.au>; Finlay, India (Health) <India.Finlay@act.gov.au>
Subject: SPIRE package - for finalisation

UNCLASSIFIED

Hi Liz

See package as currently stands. Attached:

- Arrangements brief and TP – can you review?
- Media release – all comments addressed and now includes DRAFT quotes from Bernadette. Can you review?
- Media alert – final from my perspective.
- Fact sheet – all comments addressed and text confirmed with Jakob and Kate. Currently being designed – I'll send through once this is done.

A1 poster of artist impression also being actioned. We should have this by COB.

Bringing hard copies in for your meeting with DG now.

Cheers

Trace

Tracey Pulli
 Director of Media | ACT Health Directorate

P | (02) 5124 9444 M [REDACTED]
 E | tracey.pulli@act.gov.au
 URL | www.health.act.gov.au

Meegan Fitzharris MLA

Attachment A: ARRANGEMENTS BRIEF

FUNCTION:	2019 pre-budget announcement on SPIRE
VENUE:	Outside of the Canberra Hospital Main Entrance
HOST:	Name: Liz Lopa, Executive Group Manager of Strategic Infrastructure, ACT Health Directorate Mobile: [REDACTED]
DAY:	Tuesday
DATE:	28 May 2019
TIME:	12 pm
TIME COMMITMENT:	30 minutes
CATERING:	N/A
DRESS CODE:	Business
YOUR ROLE:	To participate in a media doorstep outside of the Canberra Hospital main entrance to make a pre-budget announcement on SPIRE.
WHERE TO PARK:	There will be a car space reserved for you in the Executive Car Park behind Building 24.
WHO WILL MEET YOU:	You will be met at the main entrance to Canberra Hospital (off Hospital Road) by Michael De'Ath and Bernadette McDonald.
ADVISOR ATTENDING:	Claire Johnston
AUDIENCE:	Representatives from the ACT Health Directorate, Canberra Health Services representatives and the Australian National University and local media.
VIPs:	<p><u>ACT Health Directorate/Canberra Health Services:</u></p> <ul style="list-style-type: none"> • Michael De'Ath, Director-General of ACT Health Directorate • Bernadette McDonald, Chief Executive Officer of Canberra Health Services • Liz Lopa, Executive Group Manager of Strategic Infrastructure, ACT Health Directorate • (INSERT other CHS staff participating) • ... • ... • ... • Tracey Pulli, Director of Media, ACT Health Directorate • Charlotte Harper, Acting Director of Communications and Government Relations, Canberra Health Services <p><u>Australian National University:</u></p> <ul style="list-style-type: none"> • (INSERT other CHS staff participating) • ...

PAST INVOLVEMENT:	In December 2018 you announced the change in the location of SPIRE on the Canberra Hospital campus.
SENSITIVITIES:	There has been previous media coverage on delays with the completion of SPIRE.
ORDER OF CEREMONIES	<p>12 pm – Ms Lopa and Ms McDonald to meet Minister Fitzharris at main entrance (off Hospital Road) for the media doorstep.</p> <p>12.05 pm – Media are assembled, and doorstep commences with Minister Fitzharris addressing the media.</p> <p>12.10 pm – Minister Fitzharris to hand over the ANU representative to make comment</p> <p>12.15 pm – Minister Fitzharris to invite questions from media.</p> <p>12.20 pm – Media doorstep concludes and opportunity for overlay footage.</p> <p>12.30 pm – Event concludes and Minister free to depart.</p>
MEDIA:	Media release and media alert prepared.
SOCIAL MEDIA ACCOUNTS	Social media being coordinated through Minister's office.
OUTSTANDING REGULATORY ISSUES:	N/A

**MEDIA TALKING POINTS – PRE-BUDGET ANNOUNCEMENT ON
SPIRE
12PM, TUESDAY 28 MAY 2019**

- Health is one of the Government's biggest priorities.
- The 2019 Budget is future proofing our health care system.
- As part of this, the Government is making major investments in new health infrastructure to meet Canberra's future needs.
- At the Canberra Hospital, this includes the new Surgical Procedures, Interventional Radiology and Emergency Centre (SPIRE), which is the largest health infrastructure project in the ACT.

A bigger and better SPIRE

- Today we are announcing a bigger and better SPIRE following extensive consultation with clinicians.
- The expanded scope means SPIRE will be larger and deliver more services.
- Many of the key aspects of SPIRE have been boosted providing the best outcomes for our community and for our health workforce well into the future.
- SPIRE now deliver:
 - 114 emergency department spaces – 39 more than currently available at Canberra Hospital,
 - 22 new state of the art operating theatres – an increase from the 13 currently available and two more than originally planned,
 - 60 ICU beds – 12 more than originally ~~planned~~ and doubling what is currently available. The new ICU will also include 4 new paediatric ICU beds and have a family zone that will provide families who have children in the ICU access to accommodation and other supports~~a support area~~.
- ~~SPIRE will transform the campus and the acute health services delivered at the hospital.~~ not only transform the campus – but will transform patient experience and outcomes for our community.
- The clinicians have been integral in the development of the final scope of SPIRE. I want to thank all who have been involved in that process.

ANU announcement

- A major component SPIRE is the that it will allow for advances in the use of medical technology and techniques and for teaching and learning.
- I am pleased to be joined by the INSERT names from the Australian National University (ANU) today to also announce that SPIRE will now be complemented by a new ANU building that will boost the teaching, training and research presence on the Hospital campus.
- This is a significant announcement and a clear signal that SPIRE will not only transform the campus but will be the point of difference for health system in the ACT.
- The ANU's investment will co-locate medical research, the use of the latest technologies and clinical training and teaching at the Canberra Hospital – a feature of modern health care.
- It will ensure Canberra is best placed to attract the best and brightest students nationally and internationally to do their medical training and research at the Canberra Hospital.

Q&A

If asked about the Budget for SPIRE:

- At this stage in the project, we will not be releasing the total cost of SPIRE.
- As we are move into the procurement process for this project, it is important we don't send any pricing signals to the market.
- SPIRE is the largest health infrastructure project in the ACT and we want the best value for money for the project and the territory.
- The upcoming Budget will confirm the spend on this project for the 2019-20 financial year.

If asked about construction timeframes for the project:

- Construction of SPIRE is anticipated to be completed in 2023-24. This has not changed.
- These changes to the scope of SPIRE have been part of the early design phases of the project and will not impact on these timeframes.

Ivansson, Zoe (Health)

From: Catanzariti, John
Sent: Tuesday, 28 May 2019 8:06 AM
To: Lopa, Liz (Health)
Cc: Mooney, Colm (Health); Gray, Sophie; Esau, Lloyd
Subject: RE: SPIRE [SEC=UNCLASSIFIED]

Hi Liz,

We have received the desktop study from STH in relation to the relocation of the [REDACTED]
 [REDACTED] The file is too large to email, so I have saved a copy at:

Q:\COMMON\Filedrop\For Liz

Lloyd/Sophie – I have also saved a copy on our g-drive at:

\\act.gov.au\EDD\Procurement Solutions\Health\Projects\P4 30064 SPIRE\2. Contracts\2.1 Silver Thomas Hanley - PoC\2.1.2 Design Feasibility\Proof of Concept Business Case

Please let me know if you have any issues with accessing the file.

Regards,
 John

From: Catanzariti, John
Sent: Friday, 17 May 2019 2:22 PM
To: Lopa, Liz (Health) <Liz.Lopa@act.gov.au>
Cc: Mooney, Colm (Health) <Colm.Mooney@act.gov.au>; Gray, Sophie <Sophie.Gray@act.gov.au>; Esau, Lloyd <Lloyd.Esau@act.gov.au>
Subject: RE: SPIRE [SEC=UNCLASSIFIED]

z,

Below is what was sent to STH. Given the relatively low cost of the work and to ensure the study is ready for 28 May, we have asked STH to commence the work as soon as possible.

Further to our telephone conversation this morning, we have been requested to prepare a high level site investigation and feasibility study to relocate the [REDACTED] based on a 15,000m2 to 20,000m2 facility. A few specific things we need addressed in the study are:

- *Maximum viable floor plate and number of storeys, noting set-backs, easements;*
- *Height restrictions;*
- *Viability of frontage onto Hospital Road including any excavation constraints and impacts on surrounding buildings and services;*
- *Existing site services;*
- *Access;*
- *Territory planning and zoning constraints;*
- *Statutory Requirements;*
- *Any other relevant items to be considered.*

Could you please proceed with this work as soon as possible as a variation to your existing Proof of Concept Contract and also advise on fees associated with preparing the study.

Regards,
John

From: Lopa, Liz (Health)
Sent: Friday, 17 May 2019 2:16 PM
To: Esau, Lloyd <Lloyd.Esau@act.gov.au>; Catanzariti, John <John.Catanzariti@act.gov.au>
Cc: Mooney, Colm (Health) <Colm.Mooney@act.gov.au>; Gray, Sophie <Sophie.Gray@act.gov.au>
Subject: RE: SPIRE [SEC=UNCLASSIFIED]

Hi Guys

Can you please send me a draft of the statement of requirements for this work from STH so we can have a look and get ANU involved as well?

Thanks

Liz

From: Esau, Lloyd
Sent: Thursday, 16 May 2019 12:24 PM
To: Lopa, Liz (Health) <Liz.Lopa@act.gov.au>; Catanzariti, John <John.Catanzariti@act.gov.au>
Cc: Mooney, Colm (Health) <Colm.Mooney@act.gov.au>; Gray, Sophie <Sophie.Gray@act.gov.au>
Subject: RE: SPIRE [SEC=UNCLASSIFIED]

UNCLASSIFIED

Liz

The issue of block size is less concerning now that we have established that it is both blocks. However, absent any information about what ANU want in the medical school I suspect that STH will not be able to do much more than a rough massing study. As for risks, we will be able to look at key issues such as existing services (i.e. supply availability, relocations, etc) but that may fall short of providing a "good appreciation of the risks".

However, we will look into the other matters you mention and do what we can.

Lloyd Esau

Executive Director, Major Projects
Infrastructure Finance and Capital Works, CMTEDD

A: GPO Box 158, Canberra, ACT 2601

T: +61 (0)2 6205 3552 | M: [REDACTED]

This email, and any attachments, may be confidential and also privileged. If you are not the intended recipient please notify the sender and delete all copies of this transmission along with any attachments immediately. You should not copy or use it for any purpose, nor disclose its contents to any other person.

From: Lopa, Liz (Health)
Sent: Thursday, 16 May 2019 12:03 PM
To: Esau, Lloyd <Lloyd.Esau@act.gov.au>; Catanzariti, John <John.Catanzariti@act.gov.au>
Cc: Mooney, Colm (Health) <Colm.Mooney@act.gov.au>; Gray, Sophie <Sophie.Gray@act.gov.au>
Subject: RE: SPIRE [SEC=UNCLASSIFIED]

Thanks Lloyd

Colm and I have had a chat. Can we make sure that the feasibility work takes into account more than just "is the block big enough" and raises other potential issues that may come up ie: cutting down to hospital road and what that may involve and also what it does to remaining buildings; the services relocation that may be required along hospital road etc etc. We want a good appreciation of the risks etc so that ANU isn't taken by surprise on anything.

I'm also going to have a go at bringing together a paper for the Steering Committee on where things are at with ANU and the options that have been discussed with them, just so we have a bit of a record. Hopefully I will get to writing that in the next 48 hrs and will distribute for comment.

Thanks

Liz

From: Esau, Lloyd
Sent: Thursday, 16 May 2019 7:56 AM
To: Lopa, Liz (Health) <Liz.Lopa@act.gov.au>; Catanzariti, John <John.Catanzariti@act.gov.au>
Cc: Mooney, Colm (Health) <Colm.Mooney@act.gov.au>; Gray, Sophie <Sophie.Gray@act.gov.au>
Subject: RE: SPIRE [SEC=UNCLASSIFIED]

UNCLASSIFIED

John,

Please note that Colm called just now to confirm that the proposed [REDACTED] together so the answer to my question below has been provided.

Lloyd Esau

Executive Director, Major Projects
 Infrastructure Finance and Capital Works, CMTEDD

A: GPO Box 158, Canberra, ACT 2601

T: +61 (0)2 6205 3552 | M: [REDACTED]

This email, and any attachments, may be confidential and also privileged. If you are not the intended recipient please notify the sender and delete all copies of this transmission along with any attachments immediately. You should not copy or use it for any purpose, nor disclose its contents to any other person.

From: Esau, Lloyd
Sent: Thursday, 16 May 2019 7:23 AM
To: Lopa, Liz (Health) <Liz.Lopa@act.gov.au>; Catanzariti, John <John.Catanzariti@act.gov.au>
Cc: Mooney, Colm (Health) <Colm.Mooney@act.gov.au>; Gray, Sophie <Sophie.Gray@act.gov.au>
Subject: RE: SPIRE [SEC=UNCLASSIFIED]

UNCLASSIFIED

John,

Please note the request from Liz below. Please will you ask STH to submit a variation for this work and get this cleared through health. The work (at this stage) should only be a very high-level site analysis based on a 15-20,000 m2 facility indicating maximum viable floor plate and resultant floor count / height - noting set-backs and height restrictions. It would be good to get some preliminary advise prior to the ESC on 28 May.

[REDACTED]

Regards

Lloyd Esau

Executive Director, Major Projects
Infrastructure Finance and Capital Works, CMTEDD

A: GPO Box 158, Canberra, ACT 2601

T: +61 (0)2 6205 3552 | M: [REDACTED]

This email, and any attachments, may be confidential and also privileged. If you are not the intended recipient please notify the sender and delete all copies of this transmission along with any attachments immediately. You should not copy or use it for any purpose, nor disclose its contents to any other person.

From: Lopa, Liz (Health)
Sent: Wednesday, 15 May 2019 3:39 PM
To: Esau, Lloyd <Lloyd.Esau@act.gov.au>
Cc: Mooney, Colm (Health) <Colm.Mooney@act.gov.au>
Subject: FW: SPIRE [SEC=UNCLASSIFIED]

As discussed – we need to get some work down quickly [REDACTED] accommodate the ANU. The work also needs to reference height restrictions and whether the 'front door' can be at hospital road level

Thanks

Liz

From: McDonald, Bernadette (Health)
Sent: Wednesday, 15 May 2019 11:27 AM
To: Mooney, Colm (Health) <Colm.Mooney@act.gov.au>; Lopa, Liz (Health) <Liz.Lopa@act.gov.au>
Cc: De'Ath, Michael (Health) <Michael.De'Ath@act.gov.au>
Subject: FW: SPIRE

UNCLASSIFIED

Dear Liz and Colm,

Please see email from Russell Gruen following last weeks meeting. Can I please request that we develop some feasibility information on the options discussed and Michael and I are provided with some timeframes on these and when we will be in a position to meet with ANU again to progress.

Thanks
Bernadette

Bernadette McDonald
Chief Executive Officer
Canberra Health Services

Phone: 02 5124 2728 | **Email:** bernadette.Mcdonald@act.gov.au
Building 24, Level 2, Canberra Hospital, Yamba Drive, Garran ACT 2605

Care | Excellence | Collaboration | Integrity

Lowes, Shannon (Health)

From: Evans, Kate (Health)
Sent: Tuesday, 28 May 2019 9:04 AM
To: Lopa, Liz (Health); Culver, Jakob (Health)
Cc: Burch, Brad (Health)
Subject: RE: SPIRE Clinician Presentation [SEC=UNCLASSIFIED, DLM=Sensitive]
Attachments: 190527 CHS Senior Clinicians SPIRE Presentation 28 May 2019 KE.pptx

UNCLASSIFIED Sensitive

Updated comments attached.

Kate Evans NP

Kathleen Evans | Clinical Liaison SPIRE | Senior Project Officer

Phone: (02) 5124 9668 Email: kate.evans@act.gov.au

Strategic Infrastructure | Strategic Infrastructure & Procurement | ACT Health Directorate | ACT Government

2-6 Bowes Street, Phillip, ACT 2606 | GPO Box 825, Canberra, ACT 2601 | www.health.act.gov.au

From: Evans, Kate (Health)
Sent: Tuesday, 28 May 2019 8:24 AM
To: Lopa, Liz (Health) <Liz.Lopa@act.gov.au>; Culver, Jakob (Health) <Jakob.J.Culver@act.gov.au>
Cc: Burch, Brad (Health) <Brad.Burch@act.gov.au>
Subject: RE: SPIRE Clinician Presentation [SEC=UNCLASSIFIED, DLM=Sensitive]

UNCLASSIFIED Sensitive

Good morning Liz and Jake,

Jake – great work! The power point looks great and will certainly give the clinicians a solid understanding of where we are at and insight into what the Minister will be announcing.

On slide 3, the mental health SSU comments appear to be incomplete – “planned not to be....”. I am assuming this is where we are indicating that the MHSSU will not be collocated with the ED?

Liz, I wonder if we should point out under the Cardiac Cath Labs that we have a dedicated 27 bed ICL day unit? We have noted it in the Features of SPIRE document, but I think it would be worth mentioning it in the Clinician briefing. Your thoughts?

Happy to discuss further. K9ind regards

Kate Evans NP

Kathleen Evans | Clinical Liaison SPIRE | Senior Project Officer

Phone: (02) 5124 9668 Email: kate.evans@act.gov.au

Strategic Infrastructure | Strategic Infrastructure & Procurement | ACT Health Directorate | ACT Government

2-6 Bowes Street, Phillip, ACT 2606 | GPO Box 825, Canberra, ACT 2601 | www.health.act.gov.au

From: Lopa, Liz (Health)
Sent: Monday, 27 May 2019 4:43 PM
To: Culver, Jakob (Health) <Jakob.J.Culver@act.gov.au>; Evans, Kate (Health) <Kate.Evans@act.gov.au>
Cc: Burch, Brad (Health) <Brad.Burch@act.gov.au>
Subject: RE: SPIRE Clinician Presentation [SEC=UNCLASSIFIED, DLM=Sensitive]

Hi Jake

Sorry – used this one as I started working on it before my computer downloaded the second email! Please see attached my version with changes – I removed the m2 and changed the ANU slide a bit as I now have their media release.

Kate – can you please run your eyes over this and make sure everything AOK

Thanks so much for this Jake

Liz

From: Culver, Jakob (Health)
Sent: Monday, 27 May 2019 3:37 PM
To: Lopa, Liz (Health) <Liz.Lopa@act.gov.au>
Cc: Burch, Brad (Health) <Brad.Burch@act.gov.au>
Subject: SPIRE Clinician Presentation

UNCLASSIFIED Sensitive

Hi Liz

Please find attached draft SPIRE clinicians presentation for your review.

Please let me know if you have any questions or want any changes from my end.

Thanks
Jake

Ivansson, Zoe (Health)

From: Culver, Jakob (Health)
Sent: Wednesday, 29 May 2019 12:24 AM
To: Lopa, Liz (Health); Burch, Brad (Health)
Cc: Building Health Services Program
Subject: FW: URGENT: Budget Day Fact Sheets for review - due to MAGS 24 May 2019
Attachments: HEA CW02 SPIRE (24 May 2019).docx; HEA CW01 - Expansion of the CHWC (24 May 2019).docx; HEA CW04 - Clare Holland House (24 May 2019).docx

UNCLASSIFIED

Liz / Brad

Budget briefs for SPIRE, CHWC and CHH Expansion are attached for your review. These were put together by Finance and have been reviewed by comms, however I have suggested some changes (see attached).

Re. the headline descriptions and tables in the briefs apparently these can not be changed, as have been agreed by the Minister and Treasurer. However I have asked for clarification on CHH \$6.0 million in capital include in the table of the budget brief, as this is not included in the ACTHD Summary of the Infrastructure Program for the budget papers (I assume because capital not funded by ACT Gov budget).

For either or both of your review(s) and clearance. My email below to other corporate services divisions address other capital works projects for ACTHD, but reside in other divisions and not part of our program (e.g. smaller Calvary projects and DSD projects).

Thanks
 Jake

From: Culver, Jakob (Health)
Sent: Wednesday, 29 May 2019 12:18 AM
To: Building Health Services Program <BuildingHealthServicesProgram@act.gov.au>; DDGCorporate <DDGCorporate@act.gov.au>
Cc: Health-CIO <ACTHealthCIO@act.gov.au>; Pini, Sallyanne (Health) <Sallyanne.Pini@act.gov.au>; Milin, Marica (Health) <Marica.Milin@act.gov.au>; Donda, Jean-Paul (Health) <JeanPaul.Donda@act.gov.au>
Subject: RE: URGENT: Budget Day Fact Sheets for review - due to MAGS 24 May 2019

UNCLASSIFIED

Hi all

In the interests of expediency I note the following (and apologies if I am behind the eight ball):

- Re. the three Calvary briefs that were attached – HEA E01, HEA E03 and HEA E04 – I assume that **commissioning** will exercise review over these?
- Re. the Inner North WiC brief, given this project sits with **CHS**, I assume review and fact check will occur by them?
 (as I believe this will be contained in their infrastructure program as per the budget papers, as it is not within ACTHD's)
- Re. Core IT systems – **DSD** to review and fact check?
- All other – i.e. SPIRE, CHWC and CHH Expansion – are for **BHSP** and I have review and will provide to Brad and/or Liz for review tomorrow morning.

Mary / JP – In regards to CHH Expansion, I am a bit confused. In the BP infrastructure summary program there is no inclusion of CHH (I assume because the capital is not funded by the Territory budget). Therefore I don't see why in the budget summaries we would include \$6mill across 2019-20 to 2021-22, apparently this has been at the direction of Treasury. Advice would be appreciated.

Hope this makes, and apologies again if some of this has already been addressed. Happy to be corrected.

Thanks
Jake

From: Finlay, India (Health) **On Behalf Of** Building Health Services Program
Sent: Thursday, 23 May 2019 3:40 PM
To: Culver, Jakob (Health) <Jakob.J.Culver@act.gov.au>
Subject: FW: URGENT: Budget Day Fact Sheets for review - due to MAGS 24 May 2019
Importance: High

UNCLASSIFIED

Have you already fact checked these?

From: Dale, Emm (Health) **On Behalf Of** DDGCorporate
Sent: Thursday, 23 May 2019 3:39 PM
To: Building Health Services Program <BuildingHealthServicesProgram@act.gov.au>; Health-CIO <ACTHealthCIO@act.gov.au>
Cc: Crombie, Megan (Health) <Megan.Crombie@act.gov.au>; Pini, Sallyanne (Health) <Sallyanne.Pini@act.gov.au>; DDGCorporate <DDGCorporate@act.gov.au>
Subject: URGENT: Budget Day Fact Sheets for review - due to MAGS 24 May 2019
Importance: High

UNCLASSIFIED

Good afternoon all

Please see attached the one pager Budget Day Fact Sheets which have been prepared by Finance for your urgent review and clearance.

Can you please make any amendments using **tracked changes**.

Please note the descriptions and funding figures **are not to be changed**, these have been agreed by Ministers and the Treasurer, only **talking points** and **background** to be amended.

These briefs have already been reviewed by Comms.

Final cleared briefs are due back to MAGS **by COB tomorrow**.

Emm



BUDGET DAY BRIEF

HEA CW02

Portfolio/s: Health & Wellbeing

ISSUE: HEA CW02 – Delivering the Surgical Procedures, Interventional Radiology and Emergency Centre (SPIRE)

2019-20 Budget Paper Description:

The Government will construct the Surgical Procedures, Interventional Radiology and Emergency (SPIRE) Centre on the Canberra Hospital campus. This will deliver a purpose-built facility that provides increased capacity through new theatres, a new expanded intensive care unit, coronary care unit, a new expanded emergency department, and associated services.

	2019/20	2020/21	2021/22	2022/23	Total
	\$'000	\$'000	\$'000	\$'000	\$'000
Expenses	0	200	400	500	1,100
Capital	53,700				53,700
FTE	21.0	21.0	21.0	21.0	

Talking points:

- The SPIRE Centre will be the largest health infrastructure project delivered in the ACT, and will transform the Canberra Hospital campus for the ACT and surrounding NSW regions is a major health infrastructure project for Canberra and the surrounding region.
- SPIRE will deliver new critical and acute tertiary care infrastructure for the hospital for the Territory and surrounding region, and providing high quality, person-centric care in an environment that incorporates the latest advances in technology and Models of Care to improve healthcare outcomes and operational service efficiency.
- SPIRE will deliver 114 Emergency Department treatment spaces – 39 more than currently available at Canberra Hospital – and 60 ICU beds – 12 more than originally planned and doubling what is currently available. There will also be 4 paediatric ICU beds in SPIRE.

Cleared as complete and accurate: 18/01/2018
 Cleared by: Executive Group Manager Ext:
 Contact Officer name: Liz Lopa Ext: 49805
 Lead Directorate: Choose directorate: Health
 Cleared for release: Yes
 Information Officer name: Jakob Culver
 TRIM Ref:

Formatted: Indent: Left: 0.63 cm, No bullets or numbering



BUDGET DAY BRIEF

- SPIRE will also deliver 22 new state-of-the-art operating theatres – an increase from the 13 currently available and two more than originally planned. Theatres in SPIRE will include hybrid theatres and interventional radiology theatres that will allow for advances in the use of medical technology and techniques.
- As part of the feasibility, planning and design planning and feasibility work that has been undertaken, there has been extensive engagement with the clinical workforce, and this will continue in 2019 and beyond as early design work progresses.
- We will be working closely with our other Directorate partners, such as Environment Planning and Sustainable Development Directorate and Transport Canberra and City Services, to explore broader planning implications for the health precinct at Garran and surrounding areas.

Key / background information

- The budget includes a provision for the estimated construction costs of SPIRE, which will not be separately published so as to avoid releasing commercially sensitive information before the works are procured.
- SPIRE will be built at the eastern end of the Canberra Hospital campus, minimising disruption to existing critical care services such as the emergency department and helipad, while SPIRE is constructed.
- The SPIRE project was funded with a \$13.0 million capital injection through the 2018-19 budget process. At present \$6.5 million of this funding has been anticipated for roll-over to 2019-20. The 2019-20 Budget process has provided a further \$53.7 million capital injection for the project.
- The project is anticipated to be completed in 2023/24.

Formatted: Font: (Default) +Body (Calibri)

Formatted: Normal

Cleared as complete and accurate: 18/01/2018
 Cleared by: Executive Group Manager Ext:
 Contact Officer name: Liz Lopa Ext: 49805
 Lead Directorate: Choose directorate: Health
 Cleared for release: Yes
 Information Officer name: Jakob Culver
 TRIM Ref:



BUDGET DAY BRIEF

Formatted: Normal, Tab stops: 4.86 cm, Left

Formatted: Font: (Default) +Body (Calibri)

Cleared as complete and accurate: 18/01/2018
Cleared by: Executive Group Manager Ext:
Contact Officer name: Liz Lopa Ext: 49805
Lead Directorate: Choose directorate: Health
Cleared for release: Yes
Information Officer name: Jakob Culver
TRIM Ref:

Pond, Aleks (Health)

From: JasonSmith, Rhona (Health)
Sent: Thursday, 30 May 2019 9:58 AM
To: Culver, Jakob (Health)
Cc: Burch, Brad (Health)
Subject: SoA B8
Attachments: B8SoA20190530.xlsb

UNCLASSIFIED

Morning guys,

After several iterations, and Sally-Anne's instructions, this SoA shows the current accommodation.

Please let me know how you would like me to proceed.

Regards
Rhona

Rhona JasonSmith
P: 02 5124 9667
E: rhona.jasonsmith@act.gov.au

Senior Project Officer
Facility and Health Planning Unit | ACT Health Directorate | ACT Government
Level 5, 2-6 Bowes Street
WODEN ACT 2606



ACT
Government

ACT Health

Schedule of Accommodation | SPIRE | BUILDING 8

UNCLASSIFIED



ACT
Government

6352

ACT Health

Building Health Services Program

Modality	Current m2			Proposed m2			Total Variance from AHFG	1st Clinical Request m2			Total Variance from AHFG	Final Agreed Position m ²			Total Variance from AHFG	Comments
	Qty	Room Area	Total AHFG Area	Qty Req'd	Room Area	Total Req'd Area		Qty	Room Area	Total Area		Qty	Room Area	Total Area		
Total Room Area			1,282			277	-1,005			0	0			0	0	
Total Discounted Circulation	15%		197			41	-155			0	0			0	0	
Total Development Area			1,478			318	-1,160			0	0			0	0	
Target Gross Floor Area																

SHARED SUPPORT SERVICES AND AMENITIES

Airlock/Entry	1	6	6	0	0		-6				-6					
Toilet accessible	1	6	6	0	0		-6									
Toilet public	11	3	33	0	0		-33									
Cleaners room	1	5	5	0	0		-5									
Foyer/Kitchenette	1	62	62	0	0		-62				-62					5.1.19, 5.1.12
Sub-total			112			0	-112			0				0		
Discounted Circulation @ 10%			11			0	-11			0				0		
Total			123			0	-123			0				0		

STAFF DEVELOPMENT UNIT

OFFICES AND WORKSTATIONS

Reception	1	32	32	0	0		-32				-32					5.1.07, 5.1.08, Reception, Orientation Administrator, Capabiliti, Administrator
Office	1	19	19	0	0		-19				-19					5.1.09, Director
Office	1	8	8	0	0		-8				-8					
Office workstation	4	11	43	0	0		-43				-43					5.1.10, Work Experience Coordinator, L&D Essential Ed manager, L&D registered training org manager, other
Office workstation	5	8	38	0	0		-38				-38					BLS& neonatal trainer, E-learning developer, E-learning coordinator, office manager, hot desk x 1,
Office workstation	4	8	30	0	0		-30				-30					Pt Experience trainer, Transition to Practice manager, EN Transition to Practice program, RN Transition to Practice program
Office workstation	4	8	30	0	0		-30				-30					5.1.15, SDU, Clinical education facilitator, Clinical Skills Support officer, ADON
Office (2 person)	1	11	11	0	0		-11				-11					5.1.188, EN Transition to Practice CDNs workstations x 2
Office (3 person)	1	25	25	0	0		-25				-25					5.1.187 RN Transition to practice program CDNs, workstations x 3
Store photocopy/stationery	1	25	25	0	0		-25				-25					5.1.13, Administration area, 2 x multifunction printers, collation table x 1
Sub-total			261			0	-261			0	0			0	0	
Discounted Circulation @ 25%			65			0	-65			0	0			0	0	
Total			326			0	-326			0	0			0	0	

TEACHING AND TRAINING SPACES

Store	1	4	4	0	0		-4				-4					5.2.146
Store Equipment	1	12	12	0	0		-12				-12					Training area - basic life support equipment loan trolleys
Training room	1	162	162	0	0		-162				-162					5.2.155, 5.2.146, Training area (80) lecture style + beverage bay, retractable wall

UNCLASSIFIED



Modality	Current m2			Proposed m2			Total Variance from AHFG	1st Clinical Request m2			Total Variance from AHFG	Final Agreed Position m ²			Total Variance from AHFG	Comments
	Qty	Room Area	Total AHFG Area	Qty Req'd	Room Area	Total Req'd Area		Qty	Room Area	Total Area		Qty	Room Area	Total Area		
Total Room Area			1,282			277	-1,005			0	0			0	0	
Total Discounted Circulation	15%		197			41	-155			0	0			0	0	
Total Development Area			1,478			318	-1,160			0	0			0	0	
Training room	1	61	61	0	0		-61				-61					5.2.157, Training area (group tables 20-25) + beverage bay, retractable wall
Clinical Skills Lab (Manual Handling)	1	36	36	0	0		-36				-36					5.2.156, Manual handling- 15--18, 2 x beds, 3 x lifters, lifting equipment storage
Computer Training room	1	30	30	0	0		-30				-30					5.2.160, Computer training- 8 x training bays, 1 x trainer station
Computer Training room	1	40	40	0	0		-40				-40					5.2.161, Computer training- 8 x training bays, 1 x trainer station
Video conference room	1	36	36	0	0		-36				-36					5.2.162
Sub-total			381			0	-381			0	0			0	0	
Discounted Circulation @ 15%			57			0	-57			0	0			0	0	
Total			438			0	-438			0	0			0	0	

ANU

OFFICES AND WORKSTATIONS

Office (2 person)	1	9	9	0	0		-9				-9					5.1.21, Clinical Skills Manager & assistant L1
Office	1	10	10	0	0		-10				-10					5.2.171, ANU IT Manager L2
ANU Medical School Volunteer & Pt Recruitment Office	1	30	30	0	0		-30				-30					5.2.172, 5.2.168
IT Workshop	1	38	38	0	0		-38				-38					5.2.169, 5.2.170
Office of Research	1	36	36	0	0		-36				-36					5.2.163, 5 workstations- Link corridor
Office ANU Academic Unit of Psychological & Addiction Medicine Research Unit	1	56	56	0	0		-56				-56					5.2.164, 9 workstations- Link corridor
Computer Lab	1	74	74	0	0		-74				-74					5.2.166, 5.2.167
Sub-total			253			0	-253			0	0			0	0	
Discounted Circulation @ 25%			63			0	-63			0	0			0	0	
Total			316			0	-316			0	0			0	0	

TEACHING & TRAINING SPACES

Clinical skills teaching room	4	22	88	0	0		-88									5.1.22, 5.1.23, 5.1.24, 5.1.25 Based on consult/interview room. Requires CCTV link, Operable walls between pairs of rooms. Multipurpose . Replaces existing
Clinical skills teaching room	1	24	24	0	0		-24				-24					5.1.18, Based on consult/interview room. Requires CCTV link, Multipurpose. Replaces existing
Clinical skills teaching room	1	53	53	0	0		-53				-53					5.1.01Based on consult/interview room. Requires CCTV link, Operable walls between pairs of rooms. Multipurpose (see above). Replaces existing
Clinical skills teaching room	2	29	58	0	0		-58				-58					5.1.27, 5.1.28, Based on consult/interview room. Requires CCTV link, Multipurpose, Replaces existing
Clinical Skills Mock Resus Bay	1	26	26	0	0		-26				-26					5.1.29, Based on ED/ICU set up (2 resus bays) to allow for various scenario setups e.g. NICU, recovery etc. 2 bays with operable wall between. Replaces existing

Schedule of Accommodation | SPIRE | BUILDING 8

UNCLASSIFIED



6354

ACT Health

Building Health Services Program

Modality	Current m2			Proposed m2			Total Variance from AHFG	1st Clinical Request m2				Final Agreed Position m ²				Comments
	Qty	Room Area	Total AHFG Area	Qty Req'd	Room Area	Total Req'd Area		Qty	Room Area	Total Area	Total Variance from AHFG	Qty	Room Area	Total Area	Total Variance from AHFG	
Total Room Area			1,282			277	-1,005			0	0			0	0	
Total Discounted Circulation	15%		197			41	-155			0	0			0	0	
Total Development Area			1,478			318	-1,160			0	0			0	0	
Washup Utility	1	22	22	0	0		-22				-22				-22	5.1.02, Dishwasher, double sink, wall space for training arms drying x 3 double, 1 wall full height shelving, 1 wall open storage, wall length working bench, under bench cupboards, +++ bench height drying space, wall mounted cupboards x 2, Compactus
Store	1	4	4	0	0		-4				-4				-4	
Sub-total			275			0	-275			0	0			0	0	
Discounted Circulation @ 15%			41			0	-41			0	0			0	0	
Total			316			0	-316			0	0			0	0	

SURGICAL TRAINING CENTRE (Based on Business Case 2016)																	Comments
Room	Qty	Room Area	Total AHFG Area	Qty Req'd	Room Area	Total Req'd Area	Total Variance from AHFG	Qty	Room Area	Total Area	Total Variance from AHFG	Qty	Room Area	Total Area	Total Variance from AHFG	Total Variance from AHFG	
Reception	0	0		0	0												See Shared Administration
Waiting/breakout	0	0		1	10	10	10										Surgical handovers, clinical tutorials (seating 20-25), video conferencing, academic library, 2 workstations computer based simulation
Meeting room/ Handover room with Resource area	0	0		1	35	35	35										2 x hospital beds,Procedural, surgical or life support scenarios. AVL link up
Clinical skills laboratories	0	0		1	45	45	45										Procedural, surgical or life support scenarios. 6 workstations, 2 x AV screens per workstation AVL link upto ORs
Surgical simulation laboratories/tutorial room	0	0		1	65	65	65										Computer/e-learning/reading/library/study area/ x4 hotdesks/ beverage bav (shared)
Scrub-up gowning	0	0		1	4	4	4										Up to 20 people
Common room	0	0		2	25	50	50										Mutlipurpose, AVL link up for management supervision of remote surgical placements
Tutorial room	0	0		2	30	60	60										
Quiet room	0	0		1	7.5	8	8										
Sub-total			0			277	277			0	0			0	0		
Discounted Circulation @ 15%			0			41	41			0	0			0	0		
Total			0			318	318			0	0			0	0		

UNCLASSIFIED

Attwood, Courtney (Health)

From: Burch, Brad (Health)
Sent: Friday, 31 May 2019 10:31 AM
To: Esau, Lloyd; Catanzariti, John
Cc: Lopa, Liz (Health); Culver, Jakob (Health)
Subject: Car Parking for the new Building 24 Demountable

UNCLASSIFIED For-Official-Use-Only

Hi Lloyd and John

Jake and I met with Colm and Michael Warylo on Wednesday to discuss parking implications for SPIRE, and one of the key issues raised was the executive parking requirements for those relocating to the new Building 24 demountable. Out of the meeting, we agreed to seek some advice from STH in relation to the car park adjacent building 9 (outlined in red below).

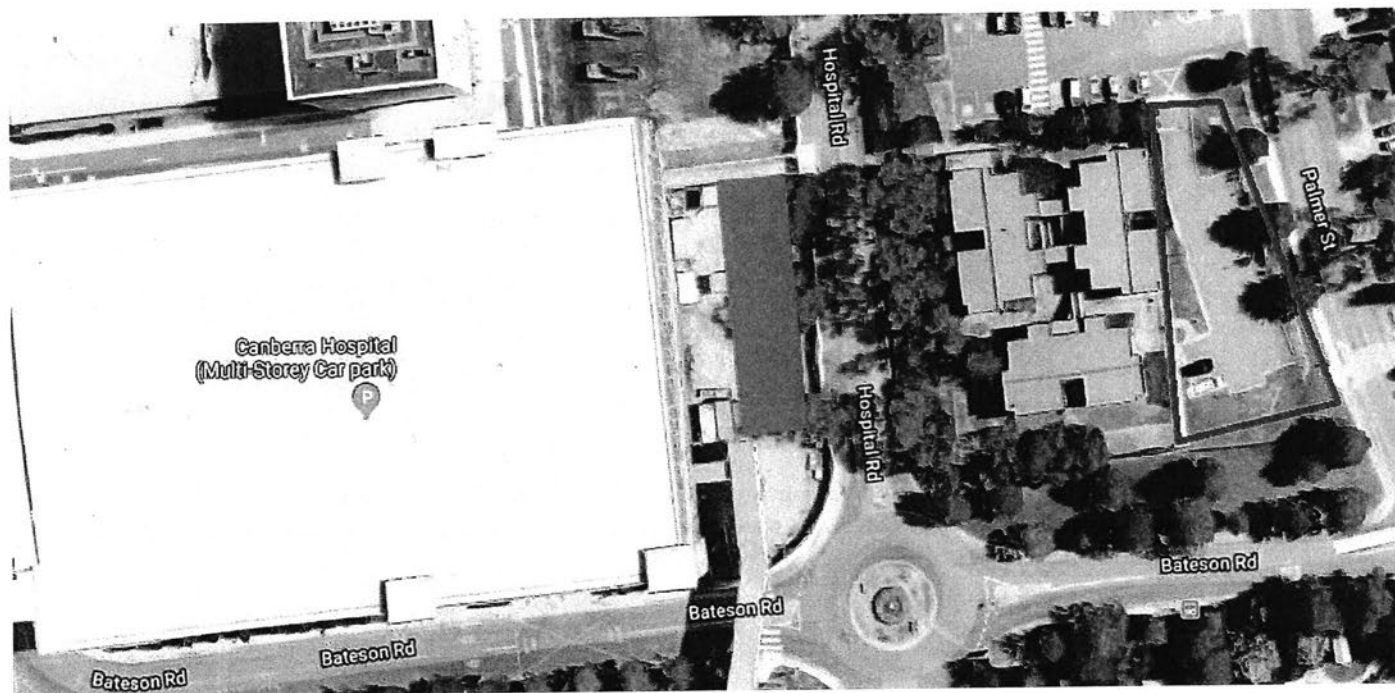

Could you please ask STH to review the area and provide options to expand the number of spaces available in the Building 9 car park – the idea would be to allocate this car park to support the new Building 24 demountable.

Happy to discuss as required.

Thanks and regards
 BB

Brad Burch | Executive Branch Manager

Strategic Infrastructure

Corporate Services

(02) 5124 9719 or [REDACTED] brad.burch@act.gov.au



ACT
 Government

ACT Health

Attwood, Courtney (Health)

From: Burch, Brad (Health)
Sent: Tuesday, 4 June 2019 9:57 AM
To: Lopa, Liz (Health)
Subject: FW: Programmer

UNCLASSIFIED

Hi Liz – just FYI.

BB

From: Esau, Lloyd
Sent: Tuesday, 4 June 2019 9:56 AM
To: Burch, Brad (Health) <Brad.Burch@act.gov.au>
Cc: Catanzariti, John <John.Catanzariti@act.gov.au>
Subject: Programmer

UNCLASSIFIED

Brad

As discussed yesterday, we propose at this stage to engage Blue Vision to work up the planning phase programmes for SPIRE and Decanting. We can review the possibility of using TCCS planning resources later – but at this stage want to get the base-line programmes in place through an external consultant.

John – please can you get the engagement of Blue Vision in place and arrange a meeting for next week so that they can commence work.

Regards

Lloyd Esau

Executive Director, Major Projects
Infrastructure Finance and Capital Works, CMTEDD

A: GPO Box 158, Canberra, ACT 2601

T: +61 (0)2 6205 3552 | **M:** [REDACTED]

This email, and any attachments, may be confidential and also privileged. If you are not the intended recipient please notify the sender and delete all copies of this transmission along with any attachments immediately. You should not copy or use it for any purpose, nor disclose its contents to any other person.

Attwood, Courtney (Health)

From: Burch, Brad (Health)
Sent: Tuesday, 4 June 2019 2:08 PM
To: Culver, Jakob (Health)
Subject: FW: SPIRE: NCPH - Extent of Site License
Attachments: Sketch Plan.pdf

UNCLASSIFIED

FYI

From: Burch, Brad (Health)
Sent: Tuesday, 4 June 2019 2:06 PM
To: Esau, Lloyd <Lloyd.Esau@act.gov.au> [REDACTED] Catanzariti, John
 <John.Catanzariti@act.gov.au>
Cc: Lopa, Liz (Health) <Liz.Lopa@act.gov.au> [REDACTED]
Subject: RE: SPIRE: NCPH - Extent of Site License

UNCLASSIFIED

Thanks Lloyd

Ernest – please find attached the sketch plan showing the area I understand to be under licence to Healthscope (the green outline). My memory failed me a little here – the licence area isn't as extensive as I suggested, but does extend nearly to Palmer Street.

Happy to discuss.

Thanks and regards

Brad

Brad Burch | Executive Branch Manager

Strategic Infrastructure

Corporate Services

☎ (02) 5124 9719 or [REDACTED] | ✉ brad.burch@act.gov.au**ACT**
Government**ACT Health**

From: Esau, Lloyd
Sent: Tuesday, 4 June 2019 9:10 AM
To: [REDACTED]; Catanzariti, John <John.Catanzariti@act.gov.au>
Cc: Burch, Brad (Health) <Brad.Burch@act.gov.au>; Lopa, Liz (Health) <Liz.Lopa@act.gov.au>; [REDACTED]
Subject: RE: SPIRE: NCPH - Extent of Site License

UNCLASSIFIED

John is off sick today and I am not sure that he has this information.

Brad – you mentioned that you had previously circulated information relating to the NCP licence / lease. This seems to have dropped through the cracks so please can you re-issue it to us and STH.

Regards

Lloyd Esau

Executive Director, Major Projects
Infrastructure Finance and Capital Works, CMTEED

A: GPO Box 158, Canberra, ACT 2601

T: +61 (0)2 6205 3552 | M: [REDACTED]

This email, and any attachments, may be confidential and also privileged. If you are not the intended recipient please notify the sender and delete all copies of this transmission along with any attachments immediately. You should not copy or use it for any purpose, nor disclose its contents to any other person.

From: [REDACTED]

Sent: Tuesday, 4 June 2019 9:06 AM

To: Catanzariti, John <John.Catanzariti@act.gov.au>; Esau, Lloyd <Lloyd.Esau@act.gov.au>

Cc: Burch, Brad (Health) <Brad.Burch@act.gov.au>; Lopa, Liz (Health) <Liz.Lopa@act.gov.au>; [REDACTED]

Subject: SPIRE: NCPH - Extent of Site License

Hi John

I refer to the PPT discussion 3 June 2019, wherein it was indicated that Healthscope have a license to use a portion of the TCH site. We would like to understand what impact this may have on the available site for the SPIRE project. Accordingly could you please forward any documentation that you may have that clarifies this arrangement. A dimensioned site plan of some form would also be particularly useful.

At the PPT we also discussed arranging a meeting with Healthscope's reps for the purposes of understanding their future needs / likely growth scenarios. As noted we had made tentative arrangements to meet with Healthscope on Friday, however I would like to understand the current site license situation before we confirm the meeting.

I look forward to your response.

Regards

[REDACTED] Managing Director



SILVER THOMAS HANLEY
PELACO COMPLEX
BUILDING 3, LEVEL 2
21-31 GOODWOOD STREET
RICHMOND, 3121
VIC, AUSTRALIA

M: [REDACTED]
T: [REDACTED]
F: [REDACTED]
E: [REDACTED]
W: sth.com.au

Message protected by MailGuard: e-mail anti-virus, anti-spam and content filtering.
<http://www.mailguard.com.au>

Licence Plan

Area to be licenced - excluding the area 6350 revised under Lease # 1086627 being Areas A & B on SL Plan # 4386 and Areas C, D, E & F on SL Plan # 4385

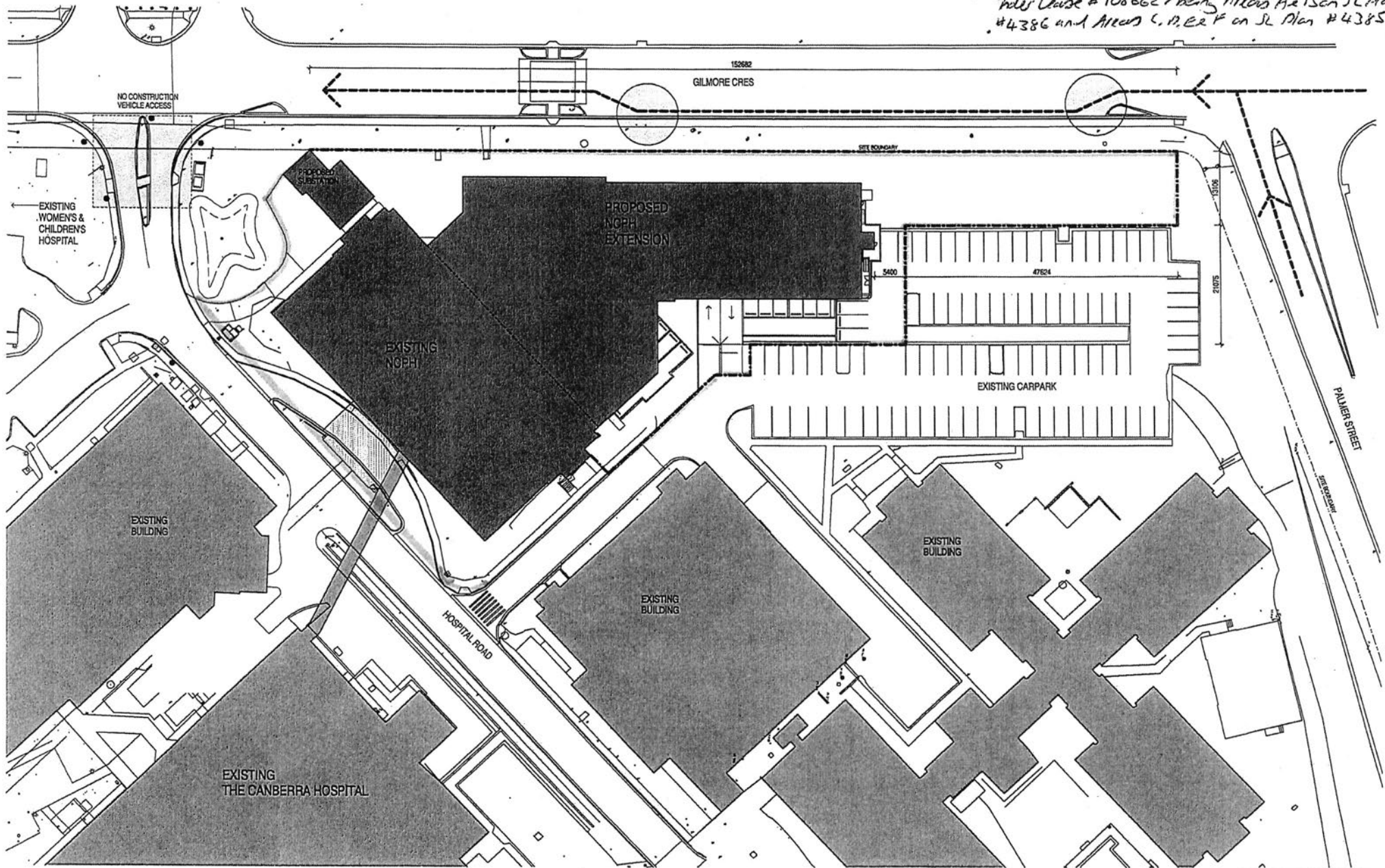

NOT FOR CONSTRUCTION

<p>Notes: This information is provided as a guide only and does not constitute a guarantee or warranty of any kind. The user of this information is responsible for its use and for any consequences arising from its use. The user of this information is also responsible for ensuring that the information is up-to-date and accurate.</p>		<p>PROJECT INFORMATION</p> <table><tr><th>NO.</th><th>DESCRIPTION</th><th>DATE</th><th>BY</th></tr><tr><td>1</td><td>PROPOSED LICENSE PLAN</td><td>2023</td><td>ARCADIA</td></tr></table>		NO.	DESCRIPTION	DATE	BY	1	PROPOSED LICENSE PLAN	2023	ARCADIA	<p>LEGEND</p> <p>PERIMETER SITE FENCE</p> <p>CONSTRUCTION VEHICLE ACCESS ROUTE</p> <p>SITE ACCESS POINT</p>		<p>APPROVED</p> <p>ARCADIA</p>		<p>DESIGNER</p> <p>TaylorThomsonWhitting</p>		<p>ENGINEER</p> <p>PSA</p>		<p>CONTRACTOR</p> <p>dwp suters</p>		<p>PROJECT MANAGER</p> <p>point</p>		<p>CLIENT</p> <p>Healthscope</p>		<p>PROJECT: NATIONAL CAPITAL PRIVATE HOSPITAL EXTENSION BLOCK 1 SECTION 19 CANBERRA HOSPITAL CAMPUS</p> <p>DRAWN: PROPOSED LICENSE PLAN</p> <table><tr><td>Scale: 1:500 to 1:1000</td><td>Date Issued: 20/09/2023 1:26 PM</td><td>Drawn: jml</td></tr><tr><td>File Name: 302792_NCP_A143A120A_proposal.dwg</td><td></td><td></td></tr><tr><td>Sheet Number: 302792 A143</td><td>Sheet Title: A143</td><td>Scale: A</td></tr></table>		Scale: 1:500 to 1:1000	Date Issued: 20/09/2023 1:26 PM	Drawn: jml	File Name: 302792_NCP_A143A120A_proposal.dwg			Sheet Number: 302792 A143	Sheet Title: A143	Scale: A
NO.	DESCRIPTION	DATE	BY																																	
1	PROPOSED LICENSE PLAN	2023	ARCADIA																																	
Scale: 1:500 to 1:1000	Date Issued: 20/09/2023 1:26 PM	Drawn: jml																																		
File Name: 302792_NCP_A143A120A_proposal.dwg																																				
Sheet Number: 302792 A143	Sheet Title: A143	Scale: A																																		

Attwood, Courtney (Health)

From: Burch, Brad (Health)
Sent: Tuesday, 4 June 2019 2:31 PM
To: Esau, Lloyd; Edghill, Duncan; Lopa, Liz (Health); Catanzariti, John; Culver, Jakob (Health)
Cc: Building Health Services Program
Subject: FW: Health Planning Consultancy - Functional Brief, MoC and HPU
Attachments: Model of Care and HPU Scope.xlsx; SPIRE Health Planning Consultant SoR - Functional Brief, MoC and HPU.docx

UNCLASSIFIED Sensitive

Hi all

Please find attached a draft Statement of Requirements for health planning consultancy based on last week's discussion, for review at this afternoon's meeting.

I have not included the Service Delivery Plan element in this draft, and I would like to discuss further with the team – if we use the SDP example from UCPH, there are a series of strategies/plans which need to be developed as part of the SDP, i.e.:

- Communication and Consultation Strategy;
- Change Management Strategy;
- Workforce Strategy;
- Risk Management Strategy;
- ICT Strategy;
- Recurrent cost plan.

While these are all essential to the project, I am not sure that a single consultant/consultancy engagement will be able to cover the breadth of this work in the time frame we require; I would suggest either a separate engagement, or including the SDP as a second phase (as design could commence while the SDP is developed).

The scope spreadsheet attached is a summary at the moment and will need to be reviewed by the clinical liaison and facility planners to ensure we have the versioning and complete list correct.

See you all soon.

Thanks and regards

Brad Burch | Executive Branch Manager

Strategic Infrastructure

Corporate Services

☎ (02) 5124 9719 or [REDACTED] ✉ brad.burch@act.gov.au



ACT
Government

ACT Health

Surgical Procedures, Interventional Radiology and Emergency (SPIRE) Centre

Health Planning Consultancy – Review of Models of Care and Development of Functional Briefing Documentation

The ACT Government recently announced the SPIRE Centre Project scope in the lead up to the 2019-20 ACT Budget. ACT Health is now focused on completing preliminary design in preparation for construction procurement and is seeking a suitably qualified and experienced consultant to support the health planning requirements for the next phase of the SPIRE Centre Project. The project scope and schedule of accommodation is outlined at Attachment A.

The successful consultant will be required to:

- Critically review health planning documentation developed to-date, including the SPIRE Centre Detailed Business Case, draft Models of Care, Health Planning Unit Briefs and Proof of Concept design documentation;
- Undertake targeted workshops with clinical and non-clinical stakeholders within Canberra Health Services and ACT Health to identify any opportunities to develop, improve or realign Models of Care and Models of Service Delivery (for non-clinical or clinical support services) with a contemporary operational or infrastructure solution. This may also include consultation with key consumer reference groups;
- Develop for consideration by the Canberra Health Services executive leadership final Models of Care and Health Planning Unit Briefs for the identified services, noting that in most cases this will be a process of updating existing documentation;
- Referencing the Models of Care and Models of Service Delivery, Health Planning Unit Briefs and Proof of Concept design documentation, develop a SPIRE Centre Functional Brief

In order to maintain the SPIRE Centre delivery program, these documents will be required as reviewed and endorsed documents by 30 September 2019. Respondents are required to outline a clear program to deliver the outcomes, including the key clinical and executive workshops and review milestones.

The functional areas for the SPIRE Project include:

- Emergency Department;
- Mental Health Short Stay Unit;
- Intensive Care Unit;
- Perioperative and Interventional Centre;
- Acute Coronary Care Unit;
- Diagnostic Imaging (Satellite);
- Surgical Inpatient Unit;
- Central Sterilising Services Department;
- Helicopter Retrieval Service;
- Loading Dock; and
- Main Entry and Reception.

Models of Care/ Service Delivery

Draft Models of Care and Health Planning Unit Briefs were completed in early 2018 to inform business case development for the SPIRE Centre, the existing Model of Care documentation includes:

- Emergency Department;
- Mental Health Short Stay Unit;
- Intensive Care Unit;
- Perioperative and Interventional Centre;
- Diagnostic Imaging; and
- Acute Coronary Care Unit.

In addition to any changes to clinical service delivery, these Models of Care will need to be updated to reflect the new SPIRE Centre location and high-level scope. In addition to the Models of Care, a Model of Service Delivery will need to be completed for Sterilising Services with the service moving from off-site to integrated delivery.

The ACT Health Model of Care template is at Attachment A, and the documents referenced above will be provided to the successful consultant on engagement.

Health Planning Unit Briefs

Similarly to the Models of Care, HPU Briefs were developed to inform the SPIRE Centre business case, including:

- Emergency Department;
- Mental Health Short Stay Unit;
- Intensive Care Unit;
- Perioperative and Interventional Centre;
- Diagnostic Imaging;
- Acute Coronary Care Unit;
- Helipad Retrieval;
- Sterilising Services; and
- Loading Dock.

In addition to the development of any other required HPU Briefs (i.e. Main Entry and Reception), these HPU Briefs will need to be updated to reflect any updates to the Models of Care and the Sterilising Services Model of Service Delivery.

The ACT Health HPU Brief template is at Attachment A, and the documents referenced above will be provided to the successful consultant on engagement.

Functional Brief

A comprehensive functional brief, summarising the Models of Care, Models of Service Delivery and HPU Briefs, is required for the SPIRE Centre project, with sufficient detail to inform detailed design and construction procurement. Consistent with previous ACT Health projects, the Functional Brief will need to include at a minimum:

- Introduction, including:
 - Description of service;
 - Future service profile;

- Overarching functional relationships, operational policy principles and design requirements;
 - General design requirements; and
 - Schedules of accommodation.
- For each functional area:
 - Description (including Model of Care outline for clinical functions);
 - Specific operational policies and design requirements;
 - Functional relationships;
 - Staff profile;
 - Changes to existing practice; and
 - Schedule of accommodation.

DRAFT

Model of Care / Health Planning Unit Briefs for SPIRE

Functional Area / Model of Care / Model of Service Delivery	Specialty Services	MoC Version	MoSD Version	HPU Version	Details / Comments
Clinical Services					
Emergency Department	Emergency Department	v0.7 2018			
	ED - Ambulance Bays (chapters)	v0.7 2018			
	ED -Bays / Adult (chapters)	v0.7 2018			ED Treatment spaces - Adult
	ED -Bays / Older Persons (chapters)	v0.7 2018			
	ED -Bays / Maternity gynae (chapters)	v0.7 2018			
	ED - Bays / Paediatrics (chapters)	v0.7 2018			Currently 6 consult 2 treatment
	ED -Fast Track, EMU, resus (chapters)	v0.7 2018			Resus 5 current + 2(includes Paeds x 1)
	ED -Adult Short Stay Unit (chapters)	v0.7 2018			Adults, Paeds, Maternity mental health TBC
	ED -Family Violence (chapters)	v0.7 2018			
	ED -Sexual Assault (chapters)	v0.7 2018			
Mental Health	Mental Health Short Stay	Apr-16			
Intensive Care Unit	ICU -Adult / HDU	v0.7 2018			Critical Care and Coronary Care
	ICU -Paediatric	v0.7 2018			2 commencing 2018/19 through CHWC expansion
Diagnostic Imaging	Medical Imaging (Outpatients & Ambulatory)	v0.4 2018			
	Interventional Radiology	v0.4 2018			
	Diagnostic Imaging - General Imaging	v0.4 2018			
	Interventional Radiology - CT	v0.4 2018			
	Diagnostic Imaging - Fluoroscopy	v0.4 2018			
	Interventional Radiology Ultrasound	v0.4 2018			
	ED imaging within ED MoC and HPU	v0.4 2018			
Perioperative and Interventional Centre	OT Pre-Rinse Sterilising Unit (chapters)	v0.5 2018			
	OT Operating Theatres - Hybrid (chapters)	v0.5 2018			
	OT - Operating Theatres - Standard (chapters)	v0.5 2018			
	OT Operating Theatres Standard- (7) standard, (6) Mat, Gynae, Paeds (chapters)	v0.5 2018			B12 x 13, SPIRE x 10 shelled, +/- procedure rooms

	OT - Paediatric Day Procedure Unit - pre-admit, recovery (chapters)	v0.5 2018			TBC - Day Surgery Unit NEW or existing
	OT - Day Surgery / Procedure Unit (beds)(chapters)	v0.5 2018			TBC - new or existing
	OT - Anaesthetic support (PACU, extended stay, 23hr unit, holding bay, recovery)(chapters)	v0.5 2018			
Inpatient Unit Brief	Surgical Inpatient Units (90% single bed rooms)				32 (shelled)
Acute Coronary Care Unit	Coronary Care - Inpatient Unit	v0.9 2018			
	Cardiac Catheterisation Laboratories	v0.9 2018			
	Electrophysiology Laboratory	v0.9 2018			
Clinical Support and Non-Clinical Services					
Sterilising Services					
Helipad Retrieval					
Main Entry and Reception					

Ivansson, Zoe (Health)

From: Burch, Brad (Health)
Sent: Tuesday, 4 June 2019 2:55 PM
To: [REDACTED]
Subject: RE: SPIRE: NCPH - Extent of Site License

UNCLASSIFIED

Thanks [REDACTED] – that was my thought as well after reviewing again.

Cheers

BB

From: [REDACTED]
Sent: Tuesday, 4 June 2019 2:51 PM
To: Burch, Brad (Health) <Brad.Burch@act.gov.au>; Esau, Lloyd <Lloyd.Esau@act.gov.au>; [REDACTED]
 [REDACTED] Catanzariti, John <John.Catanzariti@act.gov.au>
Cc: Lopa, Liz (Health) <Liz.Lopa@act.gov.au>; [REDACTED]
Subject: RE: SPIRE: NCPH - Extent of Site License

Thanks Brad,

We will overlay the perimeter onto our drawings, but on first glance, doesn't appear to be an issue with regards to the SPIRE development

[REDACTED] Associate



SILVER THOMAS HANLEY
 PELACO COMPLEX
 BUILDING 3, LEVEL 2
 21-31 GOODWOOD ST
 (PO BOX 550)
 RICHMOND 3121
 VIC, AUSTRALIA

T: [REDACTED]
 F: [REDACTED]
 E: [REDACTED]
 W:sth.com.au

From: Burch, Brad (Health) <Brad.Burch@act.gov.au>
Sent: Tuesday, 4 June 2019 2:06 PM
To: Esau, Lloyd <Lloyd.Esau@act.gov.au>; [REDACTED] Catanzariti, John
 <John.Catanzariti@act.gov.au>
Cc: Lopa, Liz (Health) <Liz.Lopa@act.gov.au>; [REDACTED]
Subject: RE: SPIRE: NCPH - Extent of Site License

UNCLASSIFIED

Thanks Lloyd

Ernest – please find attached the sketch plan showing the area I understand to be under licence to Healthscope (the green outline). My memory failed me a little here – the licence area isn't as extensive as I suggested, but does extend nearly to Palmer Street.

Happy to discuss.

Thanks and regards

Brad

Brad Burch | Executive Branch Manager

Strategic Infrastructure

Corporate Services

(02) 5124 9719 or [REDACTED] brad.burch@act.gov.au



ACT
Government

ACT Health

From: Esau, Lloyd

Sent: Tuesday, 4 June 2019 9:10 AM

To: [REDACTED] Catanzariti, John <John.Catanzariti@act.gov.au>

Cc: Burch, Brad (Health) <Brad.Burch@act.gov.au>; Lopa, Liz (Health) <Liz.Lopa@act.gov.au>; [REDACTED]

Subject: RE: SPIRE: NCPH - Extent of Site License

UNCLASSIFIED

John is off sick today and I am not sure that he has this information.

Brad – you mentioned that you had previously circulated information relating to the NCP licence / lease. This seems to have dropped through the cracks so please can you re-issue it to us and STH.

Regards

Lloyd Esau

Executive Director, Major Projects
Infrastructure Finance and Capital Works, CMTEDD

A: GPO Box 158, Canberra, ACT 2601

T: +61 (0)2 6205 3552 | M: [REDACTED]

This email, and any attachments, may be confidential and also privileged. If you are not the intended recipient please notify the sender and delete all copies of this transmission along with any attachments immediately. You should not copy or use it for any purpose, nor disclose its contents to any other person.

From: [REDACTED]

Sent: Tuesday, 4 June 2019 9:06 AM

To: Catanzariti, John <John.Catanzariti@act.gov.au>; Esau, Lloyd <Lloyd.Esau@act.gov.au>

Cc: Burch, Brad (Health) <Brad.Burch@act.gov.au>; Lopa, Liz (Health) <Liz.Lopa@act.gov.au>; [REDACTED]

Subject: SPIRE: NCPH - Extent of Site License

Hi John

I refer to the PPT discussion 3 June 2019, wherein it was indicated that Healthscope have a license to use a portion of the TCH site. We would like to understand what impact this may have on the available site for the SPIRE project. Accordingly could you please forward any documentation that you may have that clarifies this arrangement. A dimensioned site plan of some form would also be particularly useful.

At the PPT we also discussed arranging a meeting with Healthscope's reps for the purposes of understanding their future needs / likely growth scenarios. As noted we had made tentative arrangements to meet with Healthscope on Friday, however I would like to understand the current site license situation before we confirm the meeting.

I look forward to your response.

Regards



Managing Director
SILVER THOMAS HANLEY
PELACO COMPLEX
BUILDING 3, LEVEL 2
21-31 GOODWOOD STREET
RICHMOND, 3121
VIC, AUSTRALIA

M: [REDACTED]
T: [REDACTED]
F: [REDACTED]
E: [REDACTED]
W:sth.com.au

Message protected by MailGuard: e-mail anti-virus, anti-spam and content filtering.
<http://www.mailguard.com.au>

Message protected by MailGuard: e-mail anti-virus, anti-spam and content filtering.
<http://www.mailguard.com.au>

[Report this message as spam](#)

Message protected by MailGuard: e-mail anti-virus, anti-spam and content filtering.
<http://www.mailguard.com.au>

Lowes, Shannon (Health)

From: Lindemann, Monica (Health)
Sent: Tuesday, 4 June 2019 4:48 PM
To: Rad, Chadia (Health)
Cc: Burch, Brad (Health); Lopa, Liz (Health)
Subject: WVCC meeting 5 June
Attachments: SPIRE Factsheet_2019_Release 2.pdf

UNCLASSIFIED

Hi Chadia

I understand Minister Fitzharris will attend the Woden Valley Community Council Public meeting tomorrow night to talk about health investment, amongst other things.

The ACTHD Strategic Infrastructure Branch did a Building Health Services Program presentation at the WVCC meeting in March. We committed to keeping the group up-to-date on SPIRE and CHWC expansion developments.

I plan to attend tomorrow's meeting, as an observer, and can have a number of SPIRE fact sheets (attached) printed for those who are interested to collect on the night. Is there any issue with either my attendance, or having this resource available to attendees? (it is available for download on the [ACT Health website](#)). If so please let me know. Otherwise, I look forward to seeing the Minister tomorrow night.

Thanks
Monica

Monica Lindemann

Communications and Engagement Advisor
 Strategic Infrastructure Branch | ACT Health
My work days are Monday – Wednesday

lvl 4, 2-6 Bowes Street Woden ACT 2606
 t 02 5124 9191 e monica.lindemann@act.gov.au
health.act.gov.au/infrastructure

Features of SPIRE at Canberra Hospital



ACT
Government

ACT Health

Building Health Services Program



Artist impression of the SPIRE Centre at Canberra Hospital

SPIRE will include:

- 148 beds and 22 theatres
- a new and expanded Intensive Care Unit including paediatric intensive care
- a new and expanded Coronary Care Unit including interventional cardiology services
- a new and expanded Emergency Department
- integrated radiology and medical imaging facilities.

The new Surgical Procedures, Interventional Radiology and Emergency Centre (SPIRE) at the Canberra Hospital has been expanded following extensive consultation with the clinical workforce over the past 12 months. The new Centre will deliver more services for the community in a purpose-built facility.

Many of the key aspects of SPIRE have been boosted, with this state-of-the-art critical care and surgical facility able to meet the acute healthcare needs of our growing and ageing community well into the future.

SPIRE will be built at the eastern end of the hospital campus. The construction of SPIRE is anticipated to be completed in 2023-24.

Intensive Care Unit

The new Intensive Care Unit (ICU) will have 60 beds – double what is currently available.

The ICU will include:

- 4 specialist paediatric beds, originally part of the expansion of the Centenary Hospital for Women Children,
- a new family zone that will provide families who have children in the ICU access to a support area including a lounge and play area,
- a rehabilitation gymnasium to provide early, integrated rehabilitation - to get ICU patients moving to assist in their recovery,
- a dedicated pod of beds which can be converted into a complete isolation pod in the event of an infectious threat, and
- dedicated critical care bays, which will enable high-end, complex interventions, reducing the need to transfer these patients to interstate facilities.

Emergency Department

The new Emergency Department (ED) will have 114 treatment spaces – 39 more than currently available at Canberra Hospital. In addition, the new ED will include:

- 4 behavioural assessment rooms,
- bariatric and superbariatric treatment spaces,
- a separate paediatrics stream treatment area, and
- other consultation and procedural areas, including specific waiting areas for treatment streams.

Furthermore, 10 Mental Health Short Stay Unit treatment spaces will be provided in SPIRE.

Coronary Care Unit

The Coronary Care Unit will include:

- 24 acute cardiac care beds, including bariatric and isolation beds,
- 4 interventional cardiac laboratories, including one hybrid cardiac laboratory and one electrophysiology laboratory, and
- 27 interventional unit day beds.

Contacts

Further information on SPIRE and the BHSP is available on the ACT Health website.
health.act.gov.au/infrastructure | BuildingHealthServicesProgram@act.gov.au

Surgical and medical imaging facilities

SPIRE will increase the number of theatres at Canberra Hospital from 13 to 22. This will include state-of-the-art hybrid and interventional radiology theatres to allow the latest advances in medical technology to be used.

SPIRE will add to the medical imaging facilities available at Canberra Hospital, with:

- 2 new X-ray machines,
- 3 CT Scanners, and
- an MRI machine.

SPIRE will also include more inpatient wards with 64 beds for overnight care and storage spaces for important medical equipment.

Teaching and learning

The Australian National University (ANU) have announced a new ANU building that will boost the teaching, training and research presence on the Hospital campus.

This is a significant investment in the SPIRE Centre that will co-locate medical research, the use of the latest technologies and clinical training and teaching.

It will ensure Canberra is best placed to attract the best and brightest students and clinicians nationally and internationally.

The Building Health Services Program

SPIRE is part of the Building Health Services Program (BHSP), which is ensuring the changing health care needs of our rapidly growing community will continue to be met into the future.

Other major infrastructure projects as part of BHSP include the expansion of the Centenary Hospital for Women and Children, the scoping study for northside hospital services and completion of the network of five Walk-in Centres across Canberra.

Lowes, Shannon (Health)

From: Burch, Brad (Health)
Sent: Friday, 7 June 2019 12:23 PM
To: JasonSmith, Rhona (Health)
Cc: Lopa, Liz (Health)
Subject: Re: Assessing other facilities

UNCLASSIFIED

Hi Rhona

Thanks for putting this together, it comes at an opportune time.

There are ongoing discussions regarding a study tour for each functional area of the SPIRE Centre, and we have STH also looking at precedent projects for us to come up with a plan. I will forward your information on to Lloyd, who is coordinating with STH.

Cheers

Brad.

Get [Outlook for iOS](#)

From: JasonSmith, Rhona (Health) <rhona.jasonsmith@act.gov.au>
Sent: Wednesday, June 5, 2019 4:11 pm
To: Burch, Brad (Health)
Cc: Lopa, Liz (Health)
Subject: Assessing other facilities

UNCLASSIFIED

Hi Brad,

To constructively provide feedback to the contractors being appointed to review the MoC and HPU Briefs for SPIRE, I am wondering if this is an opportune time for selected clinicians and ourselves to assess other 'like' facilities by undertaking on-site visits?

The three that are relevant to Periop and Anaesthetics are Fiona Stanley in Perth, the Gold Coast University Hospital, and the Sunshine Coast University Hospital. Kate could confirm the sites for the other areas.

I have collated some information sheets identifying the relevance of these sites that I have attached.

Cheers

Rhona

Rhona JasonSmith

P: 02 5124 9667

E: rhona.jasonsmith@act.gov.au

Senior Project Officer
 Facility and Health Planning Unit
 Strategic Infrastructure and Procurement Division

ACT Health Directorate
Level 4, 4 Bowes Street
WODEN ACT 2606



ACT
Government

ACT Health

Lowes, Shannon (Health)

From: Edghill, Duncan
Sent: Monday, 10 June 2019 12:10 PM
To: Esau, Lloyd; Lopa, Liz (Health); Burch, Brad (Health)
Cc: Catanzariti, John
Subject: RE: STH Work

UNCLASSIFIED For-Official-Use-Only

Lloyd,

This is very helpful, thank you.

Thanks
 Duncan

From: Esau, Lloyd
Sent: Thursday, 6 June 2019 8:03 PM
To: Edghill, Duncan <Duncan.Edghill@act.gov.au>; Lopa, Liz (Health) <Liz.Lopa@act.gov.au>; Burch, Brad (Health) <Brad.Burch@act.gov.au>
Cc: Catanzariti, John <John.Catanzariti@act.gov.au>
Subject: RE: STH Work

UNCLASSIFIED For-Official-Use-Only

Duncan

It is appropriate that we explore this option further as it may provide better clinical and wider strategic outcome. However, your observations re B4 are correct and it is unlikely that this building will come down in the near future. The future of B4 will be the subject of the master-planning process that will run parallel to SPIRE development over the next 9 months rather than a decision arrived at as part of SPIRE planning alone. One option may be that B4 is used as a decanting resource for several years post-SPIRE as other development on the campus is pursued and is then removed if necessary to realise the master-plan vision. However, it could equally be repurposed for a more permanent function. Also, even if the master-plan contemplates removal, this could easily change as time passes and new requirements emerge. Hospital master-plans tend to be a guide rather than a bible and will need to be updated from time to time.

I have added some responses (in red) to the matters below – but rest assured this exercise is appropriate design practice and no decisions will be made without careful consideration of the implications and relative merits and ratification through the governance arrangements – including clinicians. In addition, this site analysis work will not delay advancement to the more detailed design and technical work that we need to do for the ECI tender process.

Regards

Lloyd Esau

Executive Director, Major Projects
 Infrastructure Finance and Capital Works, CMTEED

A: GPO Box 158, Canberra, ACT 2601
 T: +61 (0)2 6205 3552 | M: [REDACTED]

This email, and any attachments, may be confidential and also privileged. If you are not the intended recipient please notify the sender and delete all copies of this transmission along with any attachments immediately. You should not copy or use it for any purpose, nor disclose its contents to any other person.

From: Edghill, Duncan

Sent: Thursday, 6 June 2019 7:03 PM

To: Lopa, Liz (Health) <Liz.Lopa@act.gov.au>; Esau, Lloyd <Lloyd.Esau@act.gov.au>; Burch, Brad (Health) <Brad.Burch@act.gov.au>

Subject: STH Work

UNCLASSIFIED For-Official-Use-Only

Liz, Lloyd, Brad,

Following our conversation a few days ago, I had a few rookie questions / observations on the latest STH footprint.

I got the very strong sense that building 4 is going to be where it is for a long time yet – both because of it's remaining book value, but also because I'd imagine that demolishing a building so close to an operational SPIRE could produce its own problems. If it was necessary, this would not be an insurmountable problem. That being the case:

- Is it appropriate to base PoC design development on the possibility of B4 being removed? Or will it be more appropriate to design on the basis it will remain where it is? Whilst we are contemplating a future where B4 may be removed, this is not being considered as being a likelihood in the short, or even medium, term. Any repositioning of SPIRE has got to stack up as a better approach on the basis that B4 remains.
- If the latter – does the current STH footprint represent the most appropriate design for the site? Or does assuming B4 stays where it is lead to a different design outcome? This is yet to be proved. Given the shifting scope, and the late introduction of the ANU project, there was little opportunity to refine site analysis and optimise building form in the run up to the business case. The primary focus was on proving that the building would fit and on generating costs plans. We have a call with STH tomorrow to brief them on feedback on the adjusted footprint and to direct them to flesh out this option and provide context on why it may be a better solution. As noted above, if we elect to go this route, it will have to work with B4 remaining in place.
- If B4 stays as is – what provision is there for the future expansion of SPIRE? These issues will be explored in the work that STH will do next.
- What surrounding buildings, if any, does SPIRE need to physically link into? The clinical links are predominantly to the west – over Hospital Road. These links are not materially different for the two orientations – but again this needs to be demonstrated in the extra work that STH will do.

Thanks

Duncan

Duncan Edghill | Deputy Director-General - Transport Canberra



T 02 6205 3842 | M [REDACTED] E duncan.edghill@act.gov.au

GPO Box 158, Canberra ACT 2601

Please consider the environment before printing this e-mail.

Attwood, Courtney (Health)

From: Lopa, Liz (Health)
Sent: Wednesday, 12 June 2019 9:37 AM
To: Burch, Brad (Health)
Subject: FW: Campus works programme [SEC=UNCLASSIFIED]
Attachments: Capus Works - high level view.xlsx

From: Esau, Lloyd
Sent: Thursday, 6 June 2019 11:46 AM
To: Mooney, Colm (Health) <Colm.Mooney@act.gov.au>
Cc: Lopa, Liz (Health) <Liz.Lopa@act.gov.au>; Catanzariti, John <John.Catanzariti@act.gov.au>
Subject: Campus works programme

UNCLASSIFIED

Colm,

As discussed, the attached is a very rough high-level view. I have hidden the dates driving the bars as these have just been put in randomly to activate start/finish triggers on a quarterly basis. Please keep these dates hidden.

Hope that this is what you need for the meeting.

Lloyd Esau

Executive Director, Major Projects
 Infrastructure Finance and Capital Works, CMTEDD

A: GPO Box 158, Canberra, ACT 2601

T: +61 (0)2 6205 3552 | M: [REDACTED]

This email, and any attachments, may be confidential and also privileged. If you are not the intended recipient please notify the sender and delete all copies of this transmission along with any attachments immediately. You should not copy or use it for any purpose, nor disclose its contents to any other person.

SPIRE Programme (procurement options comparison)

[illegible]

Pond, Aleks (Health)

From: Catanzariti, John
Sent: Wednesday, 12 June 2019 9:57 PM
To: Burch, Brad (Health)
Cc: Culver, Jakob (Health); Esau, Lloyd
Subject: RE: SPIRE Design Procurements [SEC=UNCLASSIFIED]

Brad,

Are you able to advise on this?

Thanks,
John

From: Catanzariti, John
Sent: Thursday, 6 June 2019 10:45 AM
To: Burch, Brad (Health) <Brad.Burch@act.gov.au>
Cc: Culver, Jakob (Health) <Jakob.J.Culver@act.gov.au>; Esau, Lloyd <Lloyd.Esau@act.gov.au>
Subject: SPIRE Design Procurements [SEC=UNCLASSIFIED]

Brad,

We are in the process of finalising Procurement Plan Minutes for the following:

1. Principal Consultant to undertake PSP Design for the SPIRE main works;
2. Principal Consultant to undertake PSP Design for the SPIRE staging and decanting works – Sexual Health Unit and Children at Risk Health Unit.

Could you advise on who you would like to be on the Tender Evaluation Team for each procurement.

Regards,
John

Pond, Aleks (Health)

From: Evans, Kate (Health)
Sent: Wednesday, 12 June 2019 2:51 PM
To: Burch, Brad (Health)
Cc: Lopa, Liz (Health)
Subject: MoC & HPU Letters

UNCLASSIFIED

Good afternoon Brad,

As per our discussion today I have created letters for Critical Care, Surgery and Medicine for the review of the MoC and HPUs. I have created a subfolder for each. The address is as follows:-

\\act.gov.au\act health\CS\Central\Health Services Program\01. Building Health Services Program - Capital\05. Reporting - Government Business\04. Briefs - DG\190510 MoC Review CHS\MoC & HPU Review

With regards to the participants involved in the creation of these documents, there is a table with the participants at the back of each individual MoC/HPU document listing the participants. Do you need this added into the letter or is it sufficient where it is? I will place a copy of each of the MoC & HPU in the folder once we have finalised the letter.

Kind regards

Kate

Kate Evans

Kathleen Evans | Clinical Liaison SPIRE | Senior Project Officer

Phone: (02) 5124 9668 Email: kate.evans@act.gov.au

Strategic Infrastructure | Strategic Infrastructure & Procurement | ACT Health Directorate | ACT Government

2-6 Bowes Street, Phillip, ACT 2606 | GPO Box 825, Canberra, ACT 2601 | www.health.act.gov.au

Attwood, Courtney (Health)

From: Burch, Brad (Health)
Sent: Thursday, 13 June 2019 10:14 AM
To: Catanzariti, John
Subject: FW: Bed maintenance storeroom [SEC=UNCLASSIFIED]

UNCLASSIFIED

Hi John – was just thinking we might be able to add some of these to the enabling works design? Alternatively, would it be relatively straight forward to get someone off a panel or similar to undertake the design and do the minor fit-out?

Thanks
 rad.

From: Burch, Brad (Health)
Sent: Thursday, 13 June 2019 10:11 AM
To: Goodchild, Adam (Health) <Adam.Goodchild@act.gov.au>
Cc: Steele, Andrew (Health) <Andrew.Steele@act.gov.au>; Catanzariti, John <John.Catanzariti@act.gov.au>; JasonSmith, Rhona (Health) <Rhona.JasonSmith@act.gov.au>
Subject: RE: Bed maintenance storeroom [SEC=UNCLASSIFIED]

UNCLASSIFIED

Hi Adam

Thanks for your email.

At this stage we only have consultants engaged for the Proof of Concept development (Silver Thomas Hanley), and they are based interstate and focused on high-level concept design rather than on the detail.

Can I suggest that you touch base with John Catanzariti about what options there may be to support this minor project (given it is an enabling project for SPIRE Decanting). I've also copied in Rhona who is coordinating the decanting project for SPIRE.

Happy to discuss further as required.

Thanks and regards

Brad Burch | Executive Branch Manager

Strategic Infrastructure

Corporate Services

☎ (02) 5124 9719 or [REDACTED] | ✉ brad.burch@act.gov.au



ACT
Government

ACT Health

From: Goodchild, Adam (Health)
Sent: Wednesday, 12 June 2019 9:37 AM

To: Burch, Brad (Health) <Brad.Burch@act.gov.au>
Cc: Steele, Andrew (Health) <Andrew.Steele@act.gov.au>
Subject: Bed maintenance storeroom [SEC=UNCLASSIFIED]

Hi Brad,

As you are probably aware I&HSS have been tasked with relocating the bed maintenance storeroom in Bld3.

We have identified a possible area, but it will require some significant fitout to make the area hospitable to work in.

I have been advised that we may be able to piggyback off the contractor for the new SPIRE project?

Can you please advise if this is a possibility and if so, how could I get the ball rolling?

Any assistance is appreciated.

Kind regards

Adam Goodchild
Off-Site Maintenance Coordinator

Phone: 6244 2115 | Mobile: [REDACTED]

Email: adam.goodchild@act.gov.au



Care ▲ Excellence ▲ Collaboration ▲ Integrity

Attwood, Courtney (Health)

From: Esau, Lloyd
Sent: Thursday, 13 June 2019 4:13 PM
To: Burch, Brad (Health); Lopa, Liz (Health)
Cc: Catanzariti, John [REDACTED]
Subject: FW: SPIRE demolition works - pre-DA meeting consent
Attachments: TCH Form 4 DA.pdf

UNCLASSIFIED

Brad,

For some reason I failed to copy you into my email below – despite directing a task to you. These forms tend to be completed by the site owner and this is now urgent for the demo planning submission. Please can you expedite completion and return directly to STH with cc to me and John.

Apologies for the delay in getting this to you.

Lloyd Esau

Executive Director, Major Projects
 Infrastructure Finance and Capital Works, CMTEDD

A: GPO Box 158, Canberra, ACT 2601

T: +61 (0)2 6205 3552 | M: [REDACTED]

This email, and any attachments, may be confidential and also privileged. If you are not the intended recipient please notify the sender and delete all copies of this transmission along with any attachments immediately. You should not copy or use it for any purpose, nor disclose its contents to any other person.

From: Esau, Lloyd
Sent: Wednesday, 5 June 2019 6:52 AM
To: [REDACTED] Catanzariti, John <John.Catanzariti@act.gov.au>; Basic, Babita <Babita.Basic@act.gov.au>
Cc: [REDACTED]
Subject: RE: SPIRE demolition works - pre-DA meeting consent

UNCLASSIFIED

[REDACTED]

I discussed this with ACTHD yesterday pm and we are happy to grant you permission to initiate discussions with the planning authority. So that we can plan out subsequent procurements and draw up the new programme, please can you confirm the timeline for the process from your end, including:

- Completion of DA documentation
- Submission of DA
- Expected date of DA approval
- Completion of demolition tender documents (NB: we will want B24 & B8 as a single pack with B5 to be done as a separate tender).

Brad – I think that only ACTHD can complete the attached form so can I leave this with you to get it filled in and returned to STH.

Lloyd Esau

Executive Director, Major Projects
Infrastructure Finance and Capital Works, CMTEDD

A: GPO Box 158, Canberra, ACT 2601

T: +61 (0)2 6205 3552 | M: [REDACTED]

This email, and any attachments, may be confidential and also privileged. If you are not the intended recipient please notify the sender and delete all copies of this transmission along with any attachments immediately. You should not copy or use it for any purpose, nor disclose its contents to any other person.

From: [REDACTED]

Sent: Tuesday, 4 June 2019 7:12 PM

To: Catanzariti, John <John.Catanzariti@act.gov.au>; Basic, Babita <Babita.Basic@act.gov.au>; Esau, Lloyd <Lloyd.Esau@act.gov.au>

Cc: [REDACTED]

Subject: FW: SPIRE demolition works - pre-DA meeting consent

Good evening John, Lloyd and Babita,

As discussed yesterday, if IFCW and ACTHD are happy for STH and our team to initiate discussions with the relevant planning authority, we will need consent from either IFCW or ACTHD per comments below and attached document. If you are happy for us to proceed, could you please arrange for the attached form to be filled out, signed and sent back to me.

Many thanks

[REDACTED] Associate



SILVER THOMAS HANLEY
PELACO COMPLEX
BUILDING 3, LEVEL 2
21-31 GOODWOOD ST
(PO BOX 550)
RICHMOND 3121
VIC, AUSTRALIA

T: [REDACTED]
F: [REDACTED]
E: [REDACTED]
W: sth.com.au

From: [REDACTED]

Sent: Monday, 3 June 2019 12:30 PM

To: [REDACTED]

Subject: RE: SPIRE demolition works - pre-DA meeting consent

Hi [REDACTED]

Further to our phone conversation please find attached form to be signed by the appropriate ACT Health delegate under the section "Lessee's signature" only. This will provide consent for me to book a pre-DA application meeting to discuss the demolition proposal (block details are Block 1 Section 58 Garran, Lessee's name is "Australian Capital Territory c/o Property Group", however I can't fill these out without printing the form).

Thanks and let me know if any questions.

Regards,

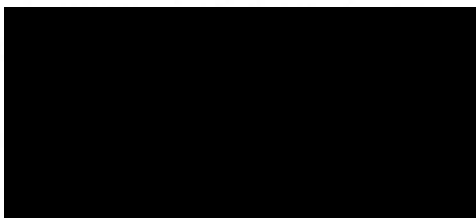

Please consider the environment before printing this email.

This message and any attachments may be privileged, confidential or proprietary. If you are not the

intended recipient of this email or believe that you have received this correspondence in error, please contact the sender through the information provided above and permanently delete this message.

Message protected by MailGuard: e-mail anti-virus, anti-spam and content filtering.
<http://www.mailguard.com.au>

[Report this message as spam](#)

Message protected by MailGuard: e-mail anti-virus, anti-spam and content filtering.
<http://www.mailguard.com.au>

ACT
 Government

 Environment, Planning and
 Sustainable Development

Planning and Development Act 2007, s425
Form 4 - LETTER OF AUTHORISATION

PRE APPLICATION MEETINGS

DEVELOPMENT APPLICATION

APPLICATION FOR RECONSIDERATION

LEASE/SITE DETAILS (Please Print)

If more than two leases/sites please attach the following details for each additional lease/site on a separate sheet

 Block Section Suburb

 Unit No. Street Address

 Block Section Suburb

 Unit No. Street Address

Describe location where no block and section details are available (e.g. for outdoor dining area location)

LESSEE(S) DETAILS - if more than two lessees please provide details of each additional lessee (Please Print)

 1st Lessee Name 2nd Lessee Name
LESSEE AUTHORISATION

 This appointment is made under the *Planning and Development Act 2007* and relates to: (please tick)

- ☐ Pre - application meeting
 ☐ Development Application
 ☐ Application for Reconsideration

 I/we the lessee(s) authorise the person/company (to be known as *the Applicant*) detailed below:

- ☐ to obtain information in relation to this site through the pre-application process
☐ to act on my/our behalf in relation to a development application for the abovementioned site/s
☐ to act on my/our behalf in relation to an application for a reconsideration of a development application for the abovementioned site/s
☐ to pay all application fees, bonds and securities, liaise with the Planning and Land Authority when required, alter, amend or provide further information as necessary and receive any communications relating to the DA or Application for Reconsideration.

APPLICANT DETAILS (Please Print)

 Applicant Name Email address

OR

 Company Name Email address
Company Nominees – a Company can list up to three nominees. The first nominee **must** be authorised to sign on behalf of the Company

 Nominee 1 Nominee 2 Nominee 3

LESSEE(S) DECLARATION if more than two lessees please provide details of each additional lessee on a separate sheet

- I/we declare that I am/we are the lessee(s) of the land described above;
- I/we have been made aware of the declaration clauses in the DA or Application for Reconsideration form; and
- I/we declare that all the information given on this form is true and complete.

1 st Lessee's Signature	<input type="text"/>	Date	<input type="text"/>
2 nd Lessee's Signature	<input type="text"/>	Date	<input type="text"/>

APPLICANT DECLARATION

- I declare that I am the person authorised to sign/sign on behalf of the company described in this form
- I declare that all the information given on this form and its attachments are true and complete;

Applicant Name	<input type="text"/>	Company Name	<input type="text"/>
Signature	<input type="text"/>	Date	<input type="text"/>

LAND CUSTODIAN AUTHORISATION

- I/we declare that I am/we are the land custodian(s) of the public land or unleased land as described above;
- I/we authorise the applicant to obtain information in relation to this site through the pre-application process and make an application for development approval.

Delegate Name	<input type="text"/>	Agency Name	<input type="text"/>
Signature	<input type="text"/>	Date	<input type="text"/>
Delegate Name	<input type="text"/>	Agency Name	<input type="text"/>
Signature	<input type="text"/>	Date	<input type="text"/>

THIS AUTHORISATION DOES NOT CONSTITUTE AN APPROVAL IN PRINCIPLE OR OTHERWISE BY THE LAND CUSTODIAN IN RELATION TO THE PROPOSED DEVELOPMENT.

Privacy Notice

The personal information on this form is provided to the Environment, Planning and Sustainable Development Directorate (EPD) to enable the processing of your application. The collection of personal information is authorised by the *Planning and Development Act 2007*. If all or some of the personal information is not collected EPSDD cannot process your application. The Planning and Development Act 2007 requires the details of applications, decisions and orders to be kept on a register and made available for public inspection. Information and documentation relevant to a development application may be made available via the Internet. The personal information you provide may be disclosed to Australian Bureau of Statistics, ACT Revenue Office, the Registrar General's Office, ACTEW Corporation, ActewAGL, Territory and Municipal Services Directorate and other Government agencies with a direct interest in the development assessment process. The information may also be disclosed where authorised by law or court order, or where the Directorate reasonably believes that the use or disclosure of the information is reasonably necessary for enforcement-related activities conducted by, or on behalf of, an enforcement body. EPSDD's Information Privacy Policy contains information about how you may access or seek to correct your personal information held by EPSDD, and how you may complain about an alleged breach of the Territory Privacy Principles. The EPSDD Information Privacy Policy can be found at www.environment.act.gov.au

Contact Details:

Environment, Planning and Sustainable Development Directorate
Customer Service Centres
GPO Box 158, Canberra City 2601
16 Challis Street Dickson ACT 2602

Business Hours: 8.30am to 4.30pm weekdays (excluding Public Holidays)
Phone: (02) 6207 1923
Email: epdcustomerservices@act.gov.au
Website: www.planning.act.gov.au

Attwood, Courtney (Health)

From: JasonSmith, Rhona (Health)
Sent: Thursday, 13 June 2019 4:14 PM
To: Burch, Brad (Health)
Subject: FW: IHSS, IFCW relocation
Attachments: Minute IHSS, IFCW relocation.docx; TCH B3 L1 FEB 2019_SPIRE options - April 2019 _STH.pdf

UNCLASSIFIED

Hi Brad,

(Please find attached a one page information sheet regarding the Staging & Decanting requirements to accommodate CARHU in their new location.

Rhona



ACT
Government

ACT Health

MINUTE

SUBJECT: Relocation requirements to accommodate the Child at Risk Health Unit

To: Brad Burch
From: Rhona JasonSmith
Date: 12 June 2019

Purpose

To provide information on the relocation movements to accommodate the Child at Risk Health Unit decant from Canberra Hospital Building 5 to Building 3 Level 1.

Background

The ACT government committed to an expansion of the Canberra Hospital (CH) in the 2016 election with the development of a Surgical Procedures, Interventional Radiology, and Emergency (SPIRE) Centre.

In December 2018, the ACT Government announced the location of the SPIRE building would be at the North end of the Eastern Corridor of the CH campus, where Buildings 5 and 24 are currently located.

To enable building to progress, the decanting and relocation of occupants and services from Building 5 and 24 will be followed by demolition of the existing buildings.

Services impacted by the decision to demolish these buildings includes the Child at Risk Health Unit.

A suitable location for the service has been identified in Building 3 Level 1. This area is currently occupied by forty-four staff from Infrastructure, Finance and Capital Works (IFCW), and Infrastructure and Health Support Services (IHSS).

Issues

The IHSS Executive Group Manager's office is located in building 3 level 1. His staff and services (including a conference room with seating capacity for fifteen) require accommodation within reasonable working distance from that executive office area.

A suitable area in Building 3 Level 1 has not been identified that can accommodate forty-four staff near the IHSS ED office. However the following two areas are capable of accommodating these numbers:

- The area currently occupied by the IHSS bed maintenance team (#14 on the attached plan). $86\text{m}^2 \times 4.4 = 19$ workstations
- The old gym (#17 on the plan), currently occupied by the Digital Solutions COWS project. $130.9\text{m}^2 \times 4.4 = 30$ workstations, plus a 42m^2 conference room.

To decant the IFCW and IHSS staff in preparation for development of the CARHU relocation site, a series of decants and refurbishments will be required:

1. IHSS Bed Maintenance to Biomed Dirty Workshop (area #14)
2. Decanted area #14 refurbished for IHSS/IFCW office space
3. Digital solutions COWS project vacated from area #17
4. Decanted area #14 refurbished for IHSS/IFCW office space & conference room

Name: Rhona JasonSmith
Title: Senior Project Officer
Branch: Facility and Health Planning Unit
Division: Strategic Infrastructure and Procurement

Date: 13/06/19

Ivansson, Zoe (Health)

From: Burch, Brad (Health)
Sent: Friday, 14 June 2019 1:48 PM
To: Catanzariti, John; Sawczuk, Joel
Cc: Esau, Lloyd; Culver, Jakob (Health); Lopa, Liz (Health)
Subject: RE: SPIRE Staging and Decanting Works [SEC=UNCLASSIFIED]

UNCLASSIFIED

Hi John – thanks for this, just wanted to add some more detail and one amendment:

- Child at Risk Health Unit – requires the following steps to allow the demolition/construction project to commence:
 - Bed Maintenance area relocated to Biomed Dirty Workshop (minor refurbishment);
 - Refurb existing Bed Maintenance area to office accommodation;
 - DSD's COWs project relocated from old gymnasium (date to be confirmed);
 - Old gymnasium to be refurbished for office accommodation; and
 - IHSS/IFCW relocated to former Bed Maintenance and gymnasium areas.
- Emergency Crisis Operations Room – this is included in the Building 24 replacement, and is no longer being relocated to Building 3.

Happy to discuss as needed.

Thanks and regards

Brad.

From: Catanzariti, John
Sent: Thursday, 13 June 2019 8:41 PM
To: Sawczuk, Joel <Joel.Sawczuk@act.gov.au>
Cc: Esau, Lloyd <Lloyd.Esau@act.gov.au>; Burch, Brad (Health) <Brad.Burch@act.gov.au>; Culver, Jakob (Health) <Jakob.J.Culver@act.gov.au>
Subject: SPIRE Staging and Decanting Works [SEC=UNCLASSIFIED]

Joel,

In preparation for next week's second programming workshop, below are some details relating to the staging and decanting strategy that needs to be included in the program:

1. Demolition works:
 - a. Building 24 (existing demountable building – less than 10 years old) is required to be demolished. This is a priority to ensure that SPIRE demolition works commence this calendar year (2019).
 - i. Occupants from Building 24 will relocate to a new two storey demountable building adjacent to the multi storey car park (building 26)
 - ii. A PMA process has already commenced for a Project Manager to undertake the construction of the new demountable.
 - b. Building 8 (aged building of 30 years plus with asbestos) is required to be demolished. This building is currently empty and once demolished will provide a vacant site for another two storey demountable building of approximately to accommodate various occupants from the existing Building 5.
 - c. Building 5 (aged building of 30 years plus with asbestos) is required to be demolished.
2. Staging and Decanting new fitouts:

- a. Child at Risk Health Unit [REDACTED]
- b. Sexual Health Unit [REDACTED]
- c. Fitout of new Emergency Crisis Operation Room - [REDACTED]

I have also attached a TCH campus plan which will assist in the understanding of location of existing buildings etc on the campus.

Please give me a call if you require any further details or clarification relating to the above.

Regards,
John



Pond, Aleks (Health)

From: Catanzariti, John
Sent: Saturday, 15 June 2019 10:31 AM
To: Sawczuk, Joel
Cc: Esau, Lloyd; Burch, Brad (Health); Culver, Jakob (Health)
Subject: RE: SPIRE Staging and Decanting Works [SEC=UNCLASSIFIED]

Joel,

Further to my email sent on Thursday, below is some additional detail for discussion and inclusion in the SPIRE program ahead of Tuesday's workshop:

- Child at Risk Health Unit – requires the following steps to allow the demolition/construction project to commence:
 - Bed Maintenance area relocated to Biomed Dirty Workshop (minor refurbishment);
 - Refurb existing Bed Maintenance area to office accommodation;
 - DSD's COWs project relocated from old gymnasium (date to be confirmed);
 - Old gymnasium to be refurbished for office accommodation; and
 - IHSS/IFCW relocated to former Bed Maintenance and gymnasium areas.
- Emergency Crisis Operations Room – this is included in the Building 24 replacement, and is no longer being relocated to Building 3.

Regards,
 John

From: Catanzariti, John
Sent: Thursday, 13 June 2019 8:41 PM
To: Sawczuk, Joel <Joel.Sawczuk@act.gov.au>
Cc: Esau, Lloyd <Lloyd.Esau@act.gov.au>; Burch, Brad (Health) <Brad.Burch@act.gov.au>; Culver, Jakob (Health) <Jakob.J.Culver@act.gov.au>
Subject: SPIRE Staging and Decanting Works [SEC=UNCLASSIFIED]

Joel,

In preparation for next week's second programming workshop, below are some details relating to the staging and decanting strategy that needs to be included in the program:

1. Demolition works:
 - a. Building 24 (existing demountable building – less than 10 years old) is required to be demolished. This is a priority to ensure that SPIRE demolition works commence this calendar year (2019).
 - i. Occupants from Building 24 will relocate to a new two storey demountable building adjacent to the multi storey car park (building 26)
 - ii. A PMA process has already commenced for a Project Manager to undertake the construction of the new demountable.
 - b. Building 8 (aged building of 30 years plus with asbestos) is required to be demolished. This building is currently empty and once demolished will provide a vacant site for another two storey demountable building of approximately to accommodate various occupants from the existing Building 5.
 - c. Building 5 (aged building of 30 years plus with asbestos) is required to be demolished.
2. Staging and Decanting new fitouts:
 - a. Child at Risk Health Unit

b. Sexual Health Unit [REDACTED]

c. Fitout of new Emergency Crisis Operation Room – [REDACTED]

I have also attached a TCH campus plan which will assist in the understanding of location of existing buildings etc on the campus.

Please give me a call if you require any further details or clarification relating to the above.

Regards,
John